

# MAGNETIC MOMENTUM ROWER MACHINE

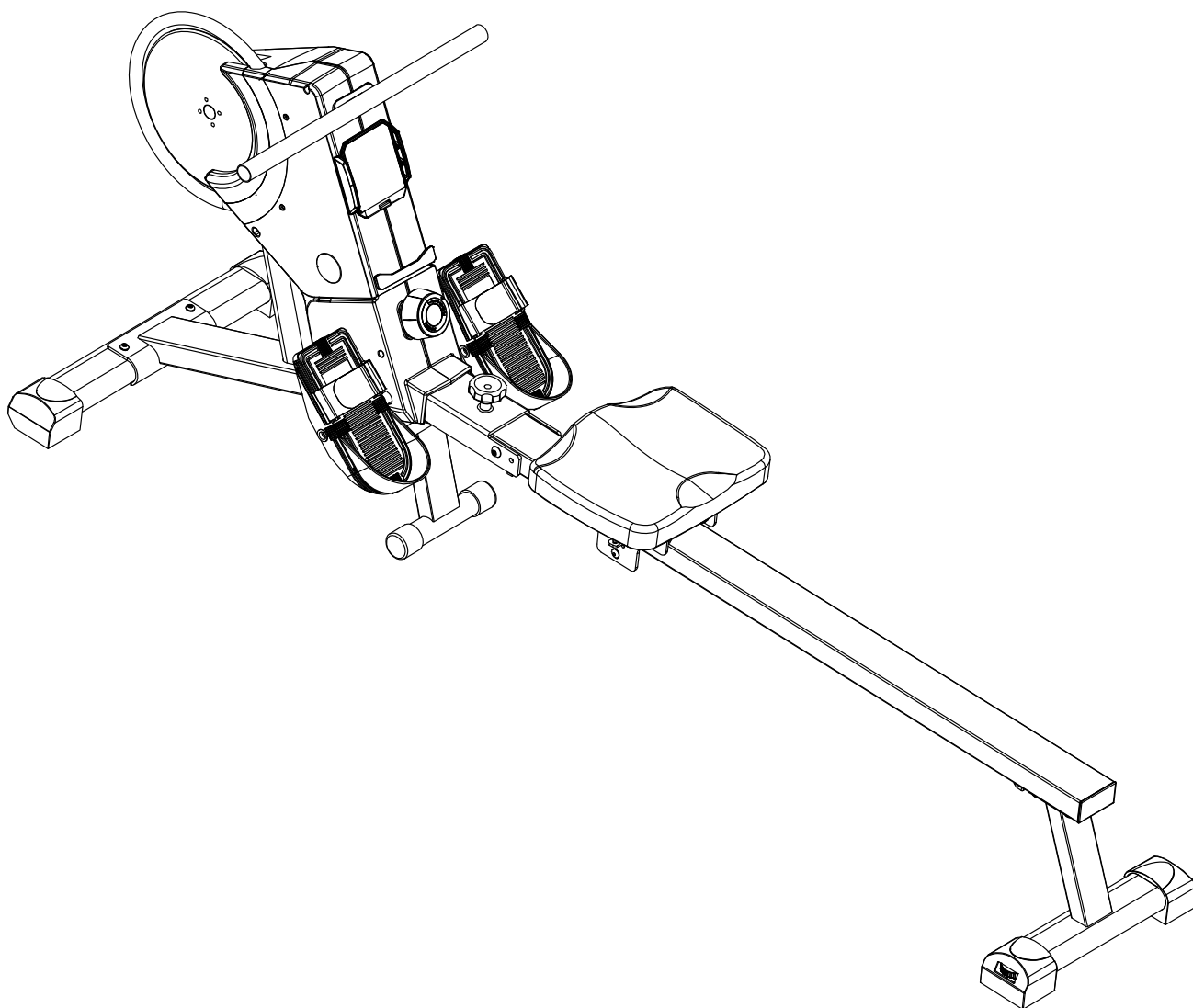

**IMPORTANT:** Read all instructions carefully before using this product.  
Retain this owner's manual for future reference.  
The specifications of this product may vary from this photo, subject to  
change without notice.



**PLEASE DO NOT RETURN THIS PRODUCT TO THE STORE.**

**STOP. Contact customer service if you have any questions regarding assembly or proper operation of the machine.**

**Email us at:**

**[Service@paradigmhw.com](mailto:Service@paradigmhw.com)**

**Or call us at:**

**1-844-641-7920**

**Hours:**

**8:00 am to 5:00 pm (PST)**

**Monday thru Friday**

# TABLE OF CONTENT

SERVICE -----	2
LABEL PLACEMENT-----	3
IMPORTANT SAFETY GUIDELINES -----	4
OVERVIEW DRAWING -----	5
PARTS LIST -----	6
HARDWARE PACK-----	8
ASSEMBLY -----	10
CONSOLE -----	17
ADJUSTMENTS & TRANSPORTING-----	19
STORAGE -----	20
TROUBLESHOOTING & MAINTENANCE-----	21
WARRANTY -----	22
PARTS REQUEST FORM-----	23

# SERVICE

## IMPORTANT: FOR NORTH AMERICA ONLY

For damaged or defective product, questions, replacement parts or any other service support, please contact our customer service department by the below methods:

**For The Best Service, please Email:**  
**[service@paradigmhw.com](mailto:service@paradigmhw.com)**

**Response Time: 1-2 Business Days**

**Emailing us with the information above will be the best method to receive a response during peak business hours**

**Website:**  
**[www.paradigmhw.com](http://www.paradigmhw.com)**

**Toll-Free:**

**1-844-641-7920**

**(8:00 AM - 5:00 PM Pacific Standard Time, Monday thru Friday)**

**Response time may vary via calling**

**Please have the following information ready when requesting for service:**

- Your name
- Phone number
- Model number
- Serial number
- Part number
- Proof of Purchase

**For damaged or defective product, please contact our customer service before returning to the store.**

**Paradigm Health & Wellness, Inc.**  
**1189 Jellick Ave.**  
**City of Industry, CA 91748, USA**

# LABEL PLACEMENT

**WARNING / AVERTISSEMENT / ADVERTENCIA**  
Do NOT pull strap past yellow stitching  
Ne tirez PAS sur la sangle au-delà des coutures jaunes  
NO tire de la correa más allá de la costura amarilla



**WARNING / AVERTISSEMENT / ADVERTENCIA**  
Pinch point, keep hands clear  
Pincez moment, garder les mains clair  
Punto Pinch, mantenga las manos alejadas



**Maximum weight capacity is 250 lbs.  
Le poids maximum pout ce produit  
est 113 kgs.  
La capacidad de peso máxima es 113 kg.**

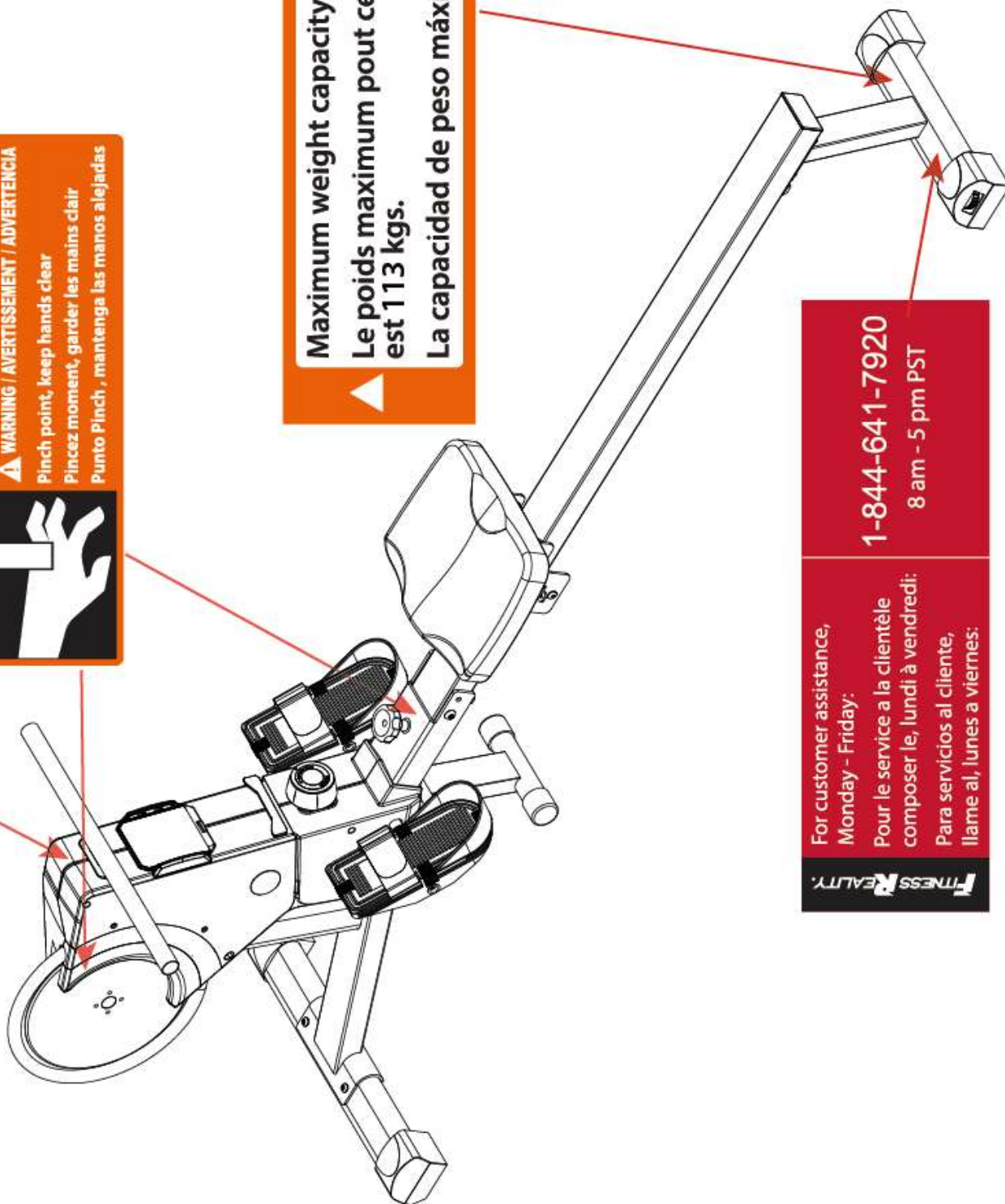

**For customer assistance,  
Monday - Friday:**  
Pour le service à la clientèle  
composer le, lundi à vendredi:  
Para servicios al cliente,  
llame al, lunes a viernes:

**1-844-641-7920**  
8 am - 5 pm PST

**FITNESS REALITY.**

# IMPORTANT SAFETY GUIDELINES

**Read all instructions before using the Rower. Basic precautions should always be followed.**

**WARNING - To reduce the risk of injury to persons, read the following:**

1. Be sure all screws, nuts, and bolts are tightened prior to use.
2. Before using this equipment, we recommend doing warm ups.
3. Only one person should be using the equipment at a time.
4. Never operate this **Rower** if it is not working properly, has been dropped, or damaged. If a problem is encountered, contact Customer Service before using the **Rower** again.
5. Always use this equipment on a clear and level surface.
6. It is recommended that you place this exercise equipment on an equipment mat.
7. For household use only.
8. Do not use outdoors or near water.
9. Use this product only for its intended use as described in this manual. Do not use attachments **NOT** recommended by the manufacturer.
10. Do not wear loose clothing when using the equipment.
11. Never drop or insert any object into any opening.
12. If at any time you feel faint, light-headed, or dizziness while operating the equipment, stop exercising immediately. You should also stop exercising if you are experiencing pain or any discomfort.
13. Keep children and pets away from equipment when in use.
14. For any problems, contact Customer Service. Servicing should be performed by an authorized service representative. Our contact number is on the service page.
15. This product requires a minimum of 6 square feet of space for safe operation.
16. **ASSEMBLE ALL HARDWARE IN THE ORDER THAT IS SHOWN IN THE ILLUSTRATIONS.**  
Serious bodily injury can occur if this equipment is not assembled and used correctly.
17. **Warning:** - Risk of Personal Injury - Keep children under the age of 13 away from the equipment.
18. **Warning:** - Risk of Personal Injury - Keep body parts, hair, loose clothing, and jewelry clear of all moving parts.
19. **Warning:** Before using this equipment, you should consult with your personal physician to see if the product is appropriate for you. Do not use this equipment without your physician's approval. Do not use this equipment if you have any of the following conditions or ailments:
  - Extreme obesity
  - Glaucoma, retinal detachment or conjunctivitis
  - Pregnancy
  - Spinal injury, Cerebral Sclerosis, or acutely swollen joints
  - Middle ear infection
  - High blood pressure, Hypertension, Recent stroke or Transient ischemic attack
  - Heart or circulatory disorders for which you are being treated
  - Hiatus hernia or Ventral hernia
  - Bone weaknesses including Osteoporosis, Unhealed fractures, Modularly pins, or Surgically implanted orthopedic supports
  - Use of anti-coagulants including Aspirin in high doses

**Warning: CANCER AND REPRODUCTIVE HARM--[WWW.P65WARNINGS.CA.GOV](http://WWW.P65WARNINGS.CA.GOV).**

**The maximum weight capacity for this product is 250 lbs / 113 kg.  
DO NOT EXCEED MAXIMUM WEIGHT CAPACITY.**

# OVERVIEW DRAWING

96	97	98	99
S5	S6		

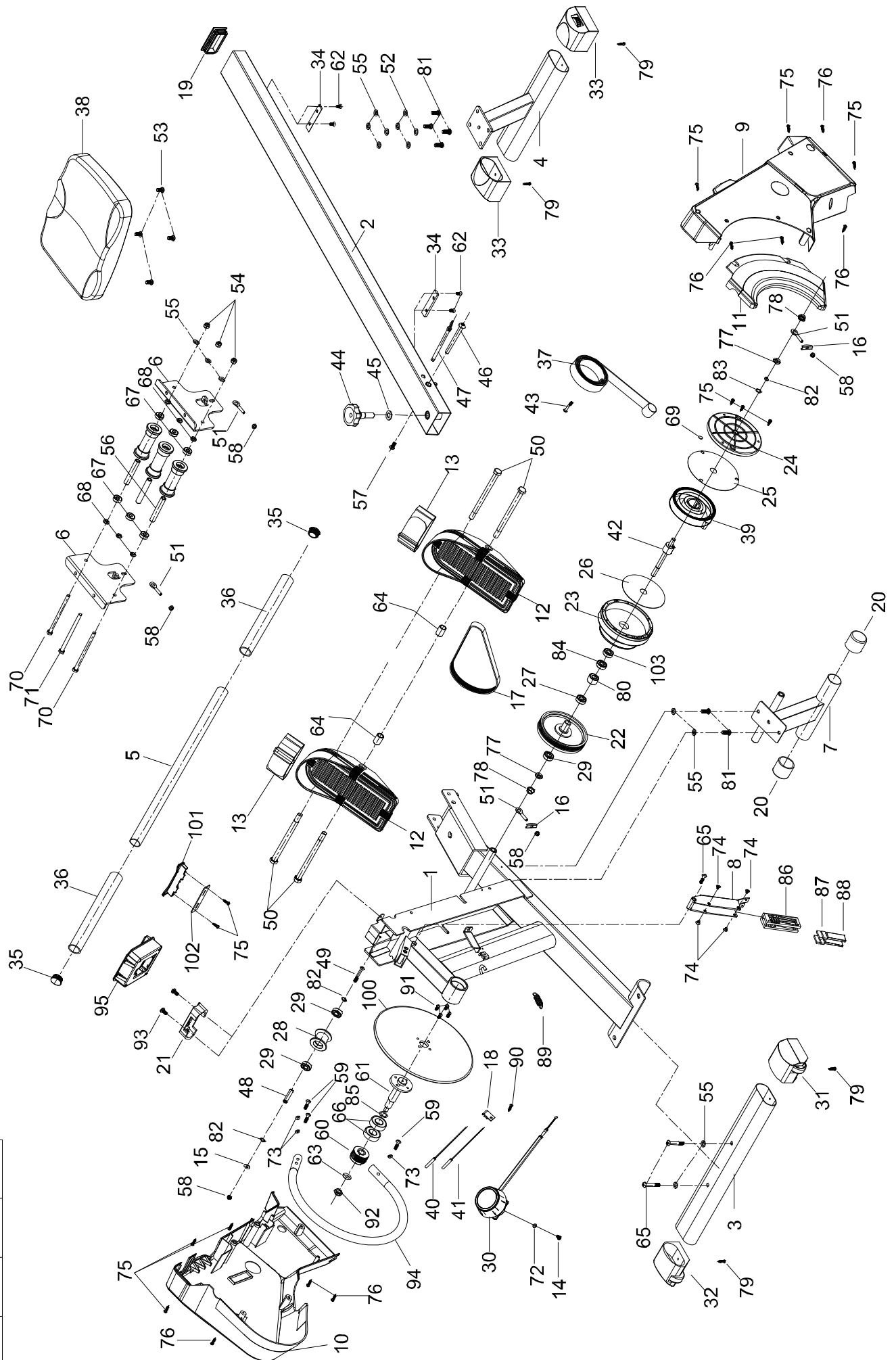



# PARTS LIST

No.	Description	Qty
1	Main Frame	1
2	Slide Tube	1
3	Front Stabilizer	1
4	Rear Stabilizer	1
5	Handlebar	1
6	Seat Plate	2
7	Central Stabilizer	1
8	Magnet Bracket A	1
9	Left Cover A	1
10	Right Cover	1
11	Left Cover B	1
12	Pedal	2
13	Pedal Strap	2
14	Phillips Screw M5*12 Galvanized	1
15	Flat Washer OD12×ID6.5×1.5	1
16	U-Bracket	2
17	Belt 6PJ340	1
18	Sensor Bracket	1
19	Slide Tube End Cap	1
20	End Cap	2
21	Handlebar Rubber Bracket	1
22	Belt Pulley	1
23	Drawstring Pulley	1
24	Spring Bumper Cover	1
25	Acoustic Baffle-A	1
26	Acoustic Baffle-B	1
27	Bearing 6003	1
28	Braid Pulley	1
29	Bearing 6000ZZ	3
30	Tension Controller	1

No.	Description	Qty
31	Left Front Stabilizer End Cap	1
32	Right Front Stabilizer End Cap	1
33	Rear Stabilizer End Cap	2
34	Rubber Pad	2
35	Handlebar End Cap	2
36	Foam Grip	2
37	Braid	1
38	Seat	1
39	Coil Spring	1
40	Sensor A	1
41	Sensor B	1
42	Axle	1
43	Phillips Screw M5×35	1
44	Round Knob	1
45	Flat Washer OD25×ID12.5×2.0	1
46	Hex Bolt Ø10×95×M6	1
47	Safety Pin Φ11*7*Φ8*106	1
48	Bushing Φ10*Φ6.1*40	1
49	Hex Bolt M6*55	1
50	Hex Bolt M12*Φ12.5*160	4
51	Eye Bolt M6*40	4
52	Spring Washer ID8.5×1.5	4
53	Round Head Hex Bolt M8*16	4
54	Nylon Nut M8	3
55	Flat Washer OD16×ID8.5×1.5	11
56	Bushing	3
57	Round Head Hex Bolt M6*16	1
58	Nylon Nut M6	5
59	Phillips Screw M6*35	3
60	Small Belt Pulley Φ43*26	1



# PARTS LIST

No.	Description	Qty
61	Flywheel Axle	1
62	Socket Phillips Screw M6*10	4
63	Flat Washer OD20×ID10.5×2	1
64	Bushing Φ18*Φ13*26	2
65	Round Head Hex Bolt M8*45	3
66	Bearing 6004	2
67	Bearing 608ZZ	6
68	Bushing Φ12.7*Φ8.2*7	6
69	Magnet Φ10*2	1
70	Hex Bolt M8*125	2
71	Hex Bolt M8*130	1
72	Flat Washer OD11×ID5.5×1.5	1
73	Wave Washer OD16*ID6.5*T1.0	3
74	Self-Tapping Phillips Screw ST5.0*10	4
75	Self-Drilling Phillips Screw ST4.0*19	11
76	Self-Tapping Phillips Screw ST4.0*16	7
77	Hex Nut M10*P1.0*H5	2
78	Flange Nut M10×1.0	2
79	Self-Tapping Phillips Screw ST4.0*25	4
80	One direction Bearing HR1712	1
81	Round Head Hex Bolt M8×20,S6	6
82	C-Ring Ø10	3

No.	Description	Qty
83	Wave WasherOD13.5*ID10.2*0.4	1
84	Bearing 16003	1
85	Wave WasherOD27.2*ID20.8*T0.4	1
86	Magnet Bracket B	1
87	Small Magnet 10*20*5	4
88	Large Magnet 20*50*5	2
89	Spring Ø14*1.5*55	1
90	Self-Tapping Phillips Screw ST4.0*12	1
91	Hex Bolt M6*15	4
92	Nylon Nut M10	1
93	Phillips Screw M5*12 Chromium	2
94	Tube	1
95	Console	1
96	5mm Allen Wrench	1
97	6mm Allen Wrench	1
98	Multi-Hex Tool with Phillips Screwdriver	1
99	Open Wrench	1
100	Aluminum Plate	1
101	Phone Holder	1
102	Bracket	1
103	Bearing	1

## 2638-Hardware Pack-1

### step 1

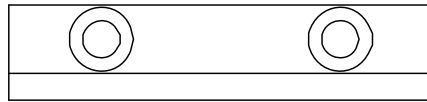

{34} Rubber Pad 1PC



{62} Socket Phillips Screw 2PCS

### step 2

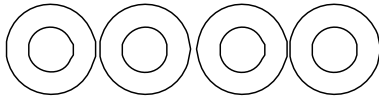

{55} Flat Washer 4PCS

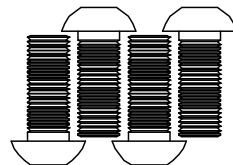

{81} Round Head  
Hex Bolt 4PCS

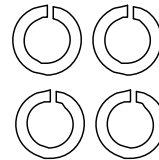

{52} Spring Washer 4PCS

### step 3



{65} Round Head Hex Bolt  
2PCS

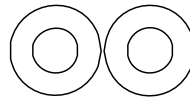

{55} Flat Washer  
2PCS

### step 4

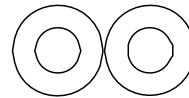

{55} Flat Washer  
2PCS

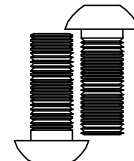

{81} Round Head Hex  
Bolt 2PCS

### step 5

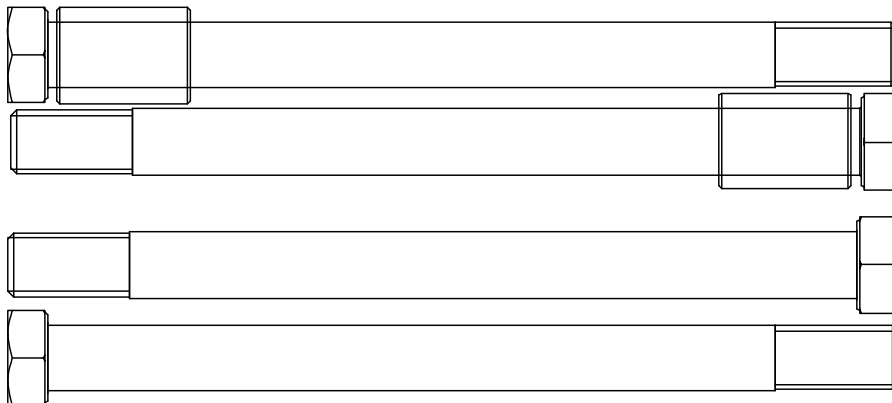

{50} Hex Bolt 4pcs

{64} Bushing 2PCS

## 2638-Hardware Pack-2

### step 6

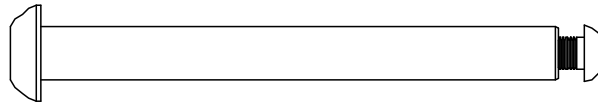

(46) Hex Bolt 1PC

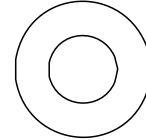

(45) Flat Washer 1PC

(57) Round Head Hex Bolt 1PC

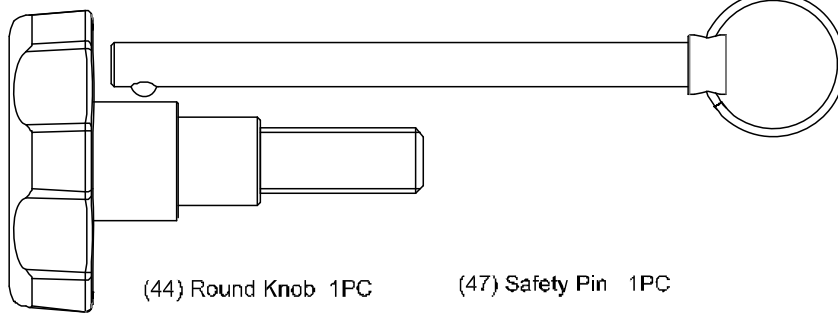

(44) Round Knob 1PC

(47) Safety Pin 1PC

### Tool

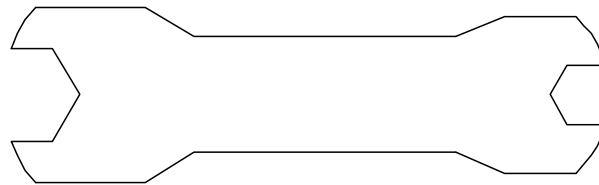

Open Wrench 1PC

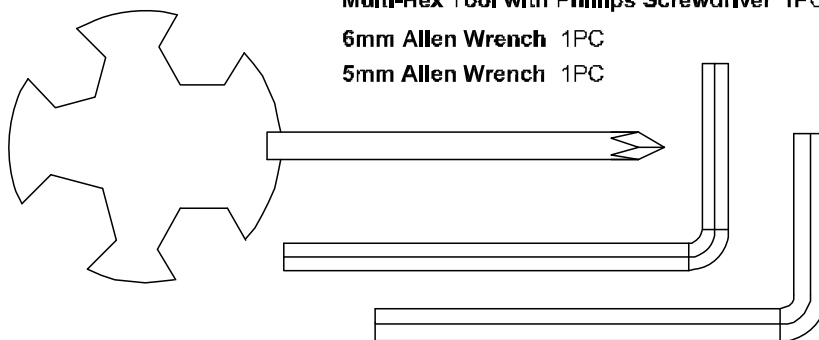

Multi-Hex Tool with Phillips Screwdriver 1PC

6mm Allen Wrench 1PC

5mm Allen Wrench 1PC

# ASSEMBLY

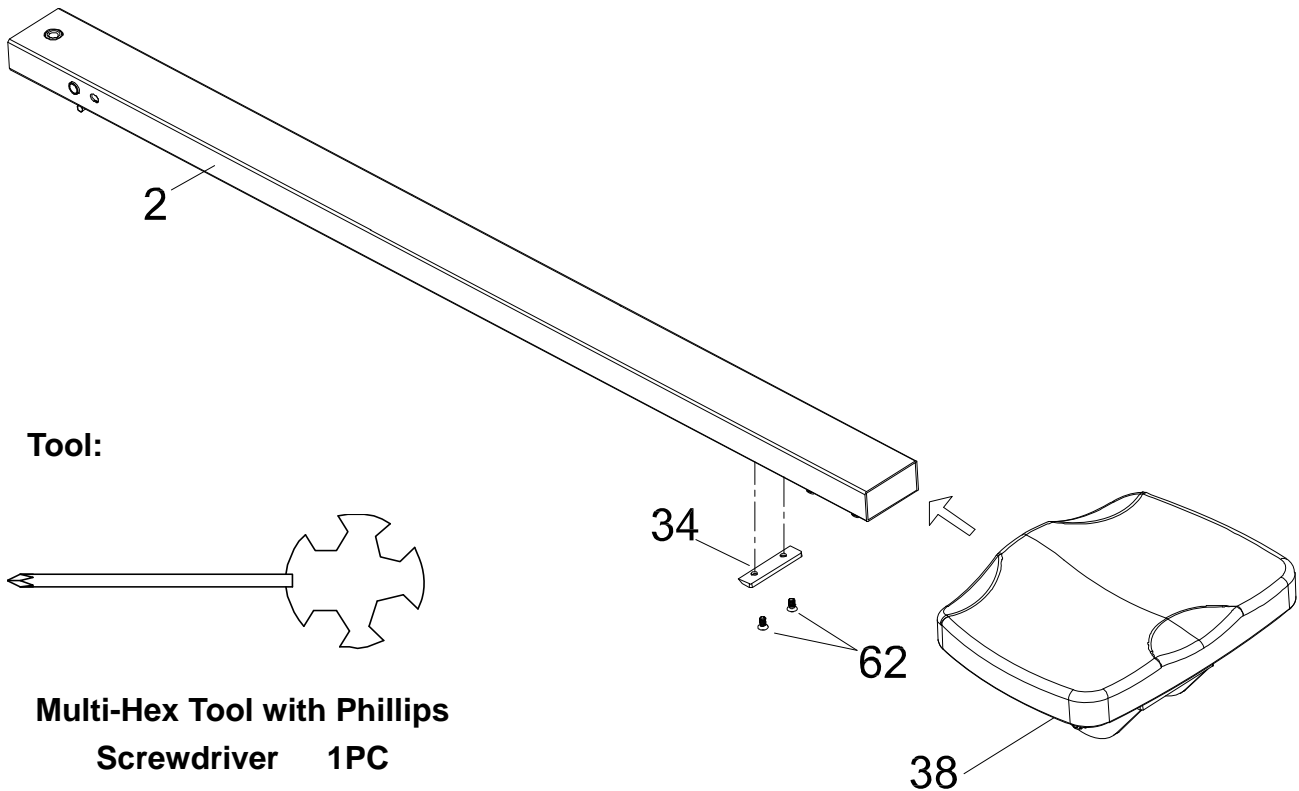

## Step 1

### 1A. Installing the Seat

Slide the **Seat (38)** onto the **Sliding Tube (2)**. Attach the **Rubber Pad (34)** onto the underside of the **Sliding Tube (2)** with two **Socket Phillips Screws (62)**. Tighten the hardware using the **Multi-Hex Tool with Phillips Screwdriver** provided.

**NOTE:** The narrow edge of the **Rubber Pad (34)** should be pointing towards the **Seat (38)**.

### Hardware:

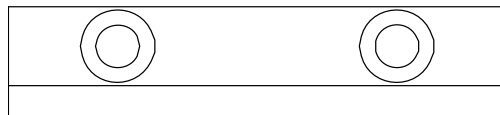

**(34) Rubber Pad**  
1 PC



**(62) Socket Phillips Screw**  
2 PCS

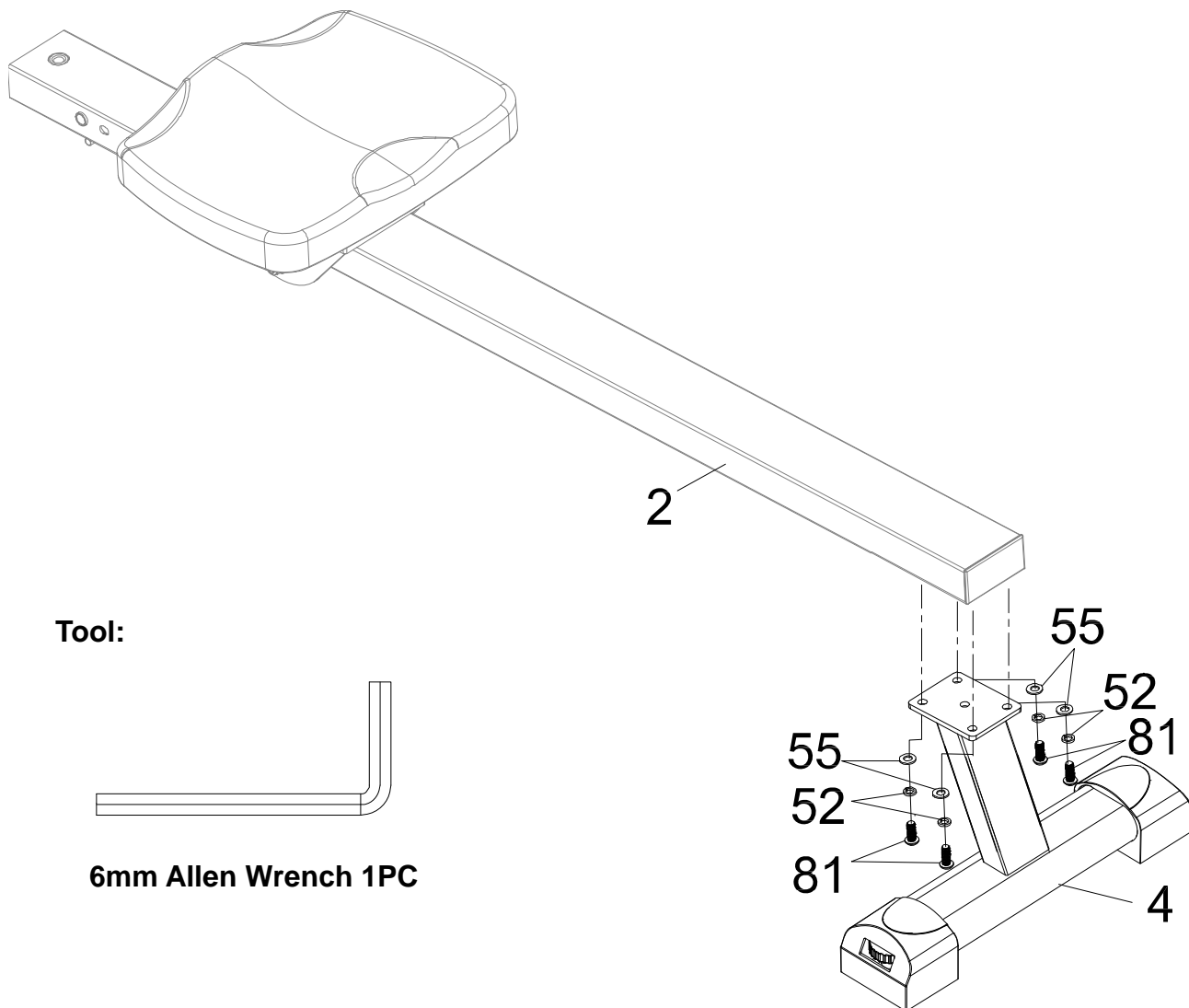

Tool:



6mm Allen Wrench 1PC

## Step 2

### 2A. Installing the Rear Stabilizer

Attach the **Rear Stabilizer (4)** onto the underside of the **Sliding Tube (2)** with four **Flat Washers (55)**, four **Spring Washers (52)**, and four **Round Head Hex Bolts (81)**. Tighten the hardware using the **6mm Allen Wrench** provided.

Hardware :

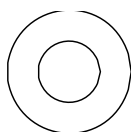

(55) Flat Washer  
4 PCS

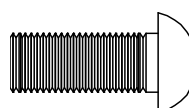

(81) Round Head  
Hex Bolt  
4 PCS

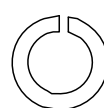

(52) Spring Washer  
4 PCS

# ASSEMBLY

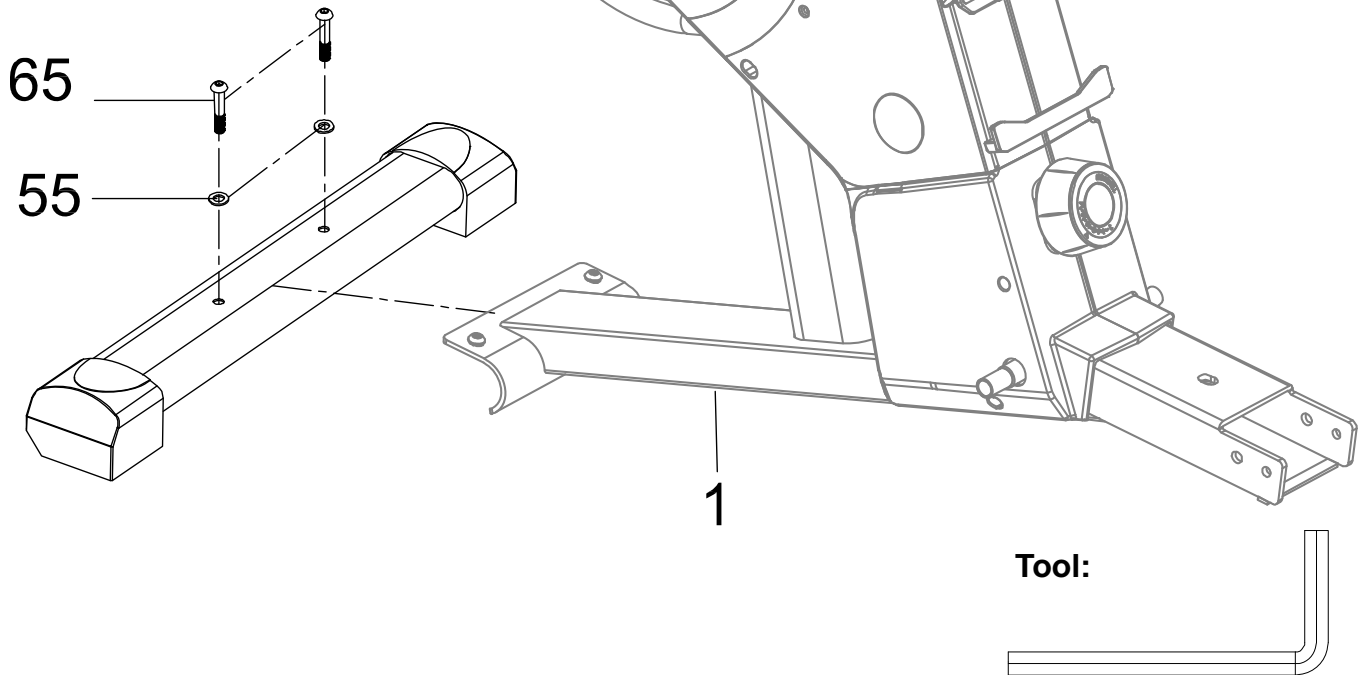
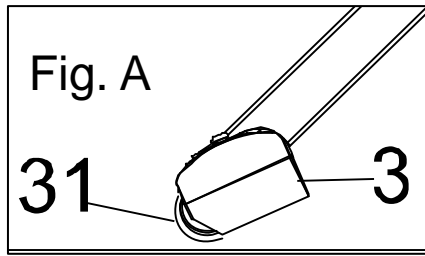

5mm Allen Wrench 1PC

## Step 3

### 3A. Installing the Front Stabilizer

Attach the **Front Stabilizer (3)** onto the **Main Frame (1)** with two **Flat Washers (55)**, and two **Round Head Hex Bolts (65)**. Tighten the hardware using the **5 mm Allen Wrench** provided.

**Note:** The wheel on the **Left Front Stabilizer End Cap (31)** should be facing forward when installing the **Front Stabilizer (3)**. See Fig. A.

Hardware :

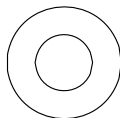

(55) Flat Washer  
2 PCS

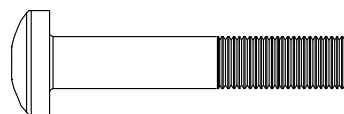

(65) Round Head  
Hex Bolt  
2 PCS

# ASSEMBLY

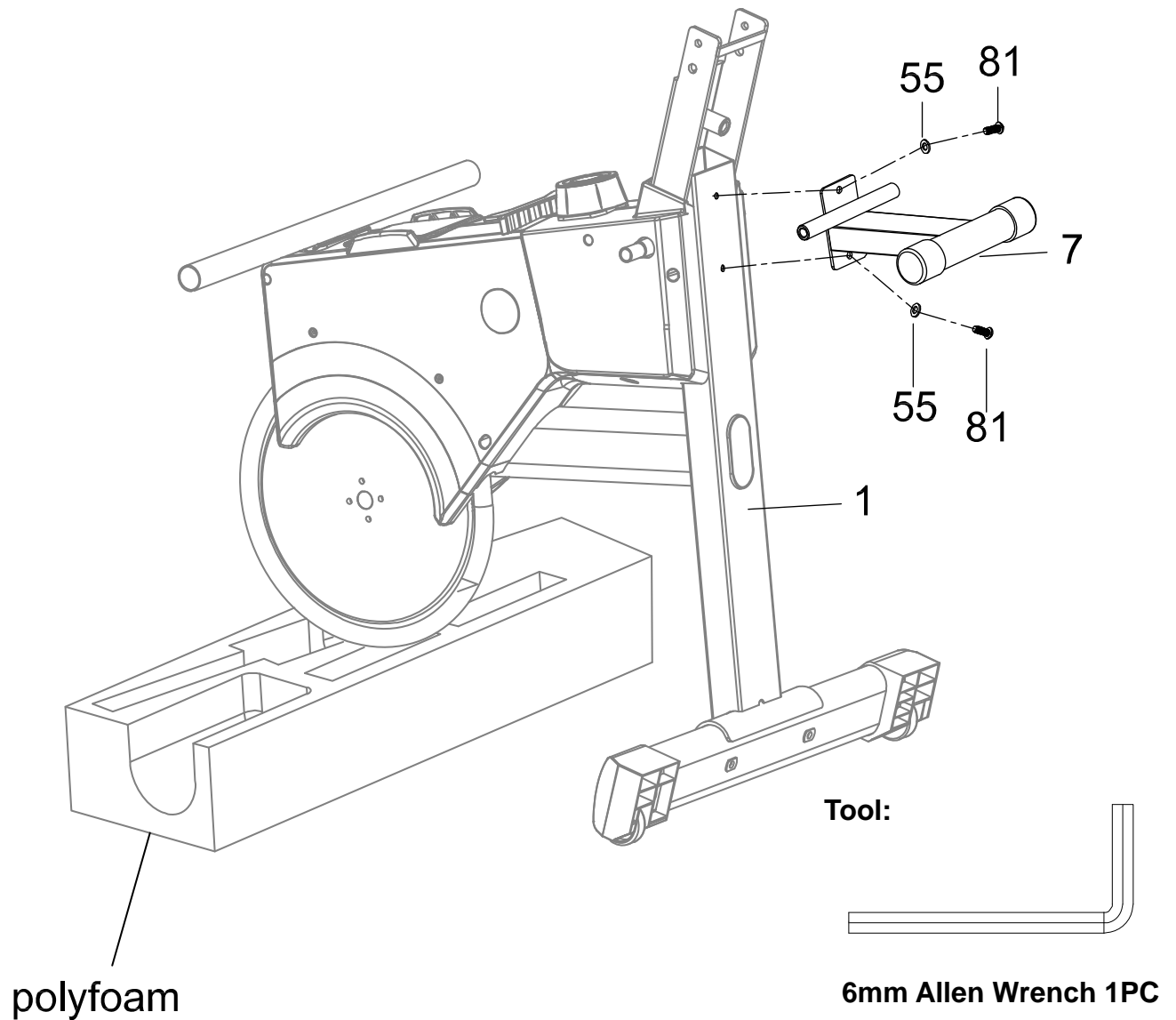

## Step 4

### 4A. Installing the Central Stabilizer

Place a block of the packaging **polyfoam** in front of the **Main Frame (1)**. Lift the **Main Frame (1)** rest the machine on the **polyfoam** to help hold the frame up. Attach the **Central Stabilizer (7)** onto the bottom of the **Main Frame (1)** with two **Flat Washers (55)** and two **Round Head Hex Bolts (81)**. Tighten the hardware using the **6mm Allen Wrench** provided.

Hardware :

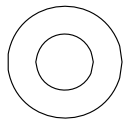

(55) Flat Washer  
2 PCS

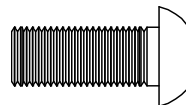

(81) Round Head  
Hex Bolt  
2 PCS



# ASSEMBLY

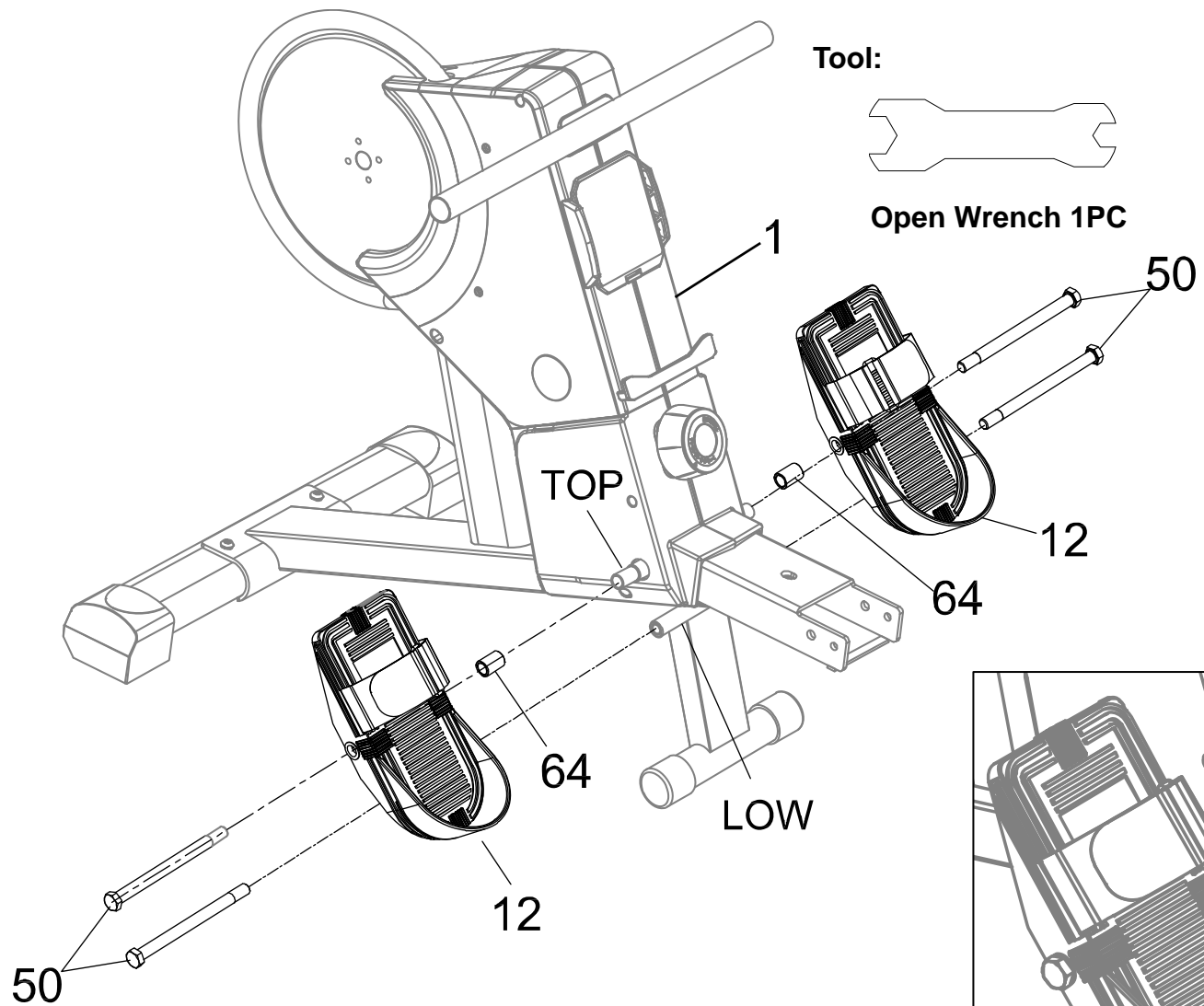

## Step 5

### 5A. Installing the Pedals

Attach one **Hex Bolt (50)** into the **LOW** bolt hole on the left side of the **Main Frame (1)**. Tighten using the **Open Wrench** provided.

Slide one **Hex Bolt (50)** through the center of the **Pedal (12)**, then slide a **Bushing (64)** onto the end of that **Hex Bolt (50)**. Attach the group of parts to the **TOP** bolt hole on the left side of the **Main Frame (1)**. Tighten using the **Open Wrench** provided.

Repeat **5A** for the left side.

NOTE: The heel of the **Pedals (12)** will rest on the lower **Hex Bolt (50)**. See **Fig. B**

### Hardware:

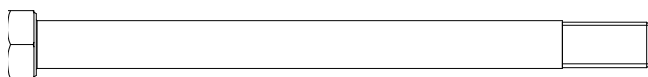

(50) Hex Bolt  
4 PCS



(64) Bushing  
2 PCS

# ASSEMBLY

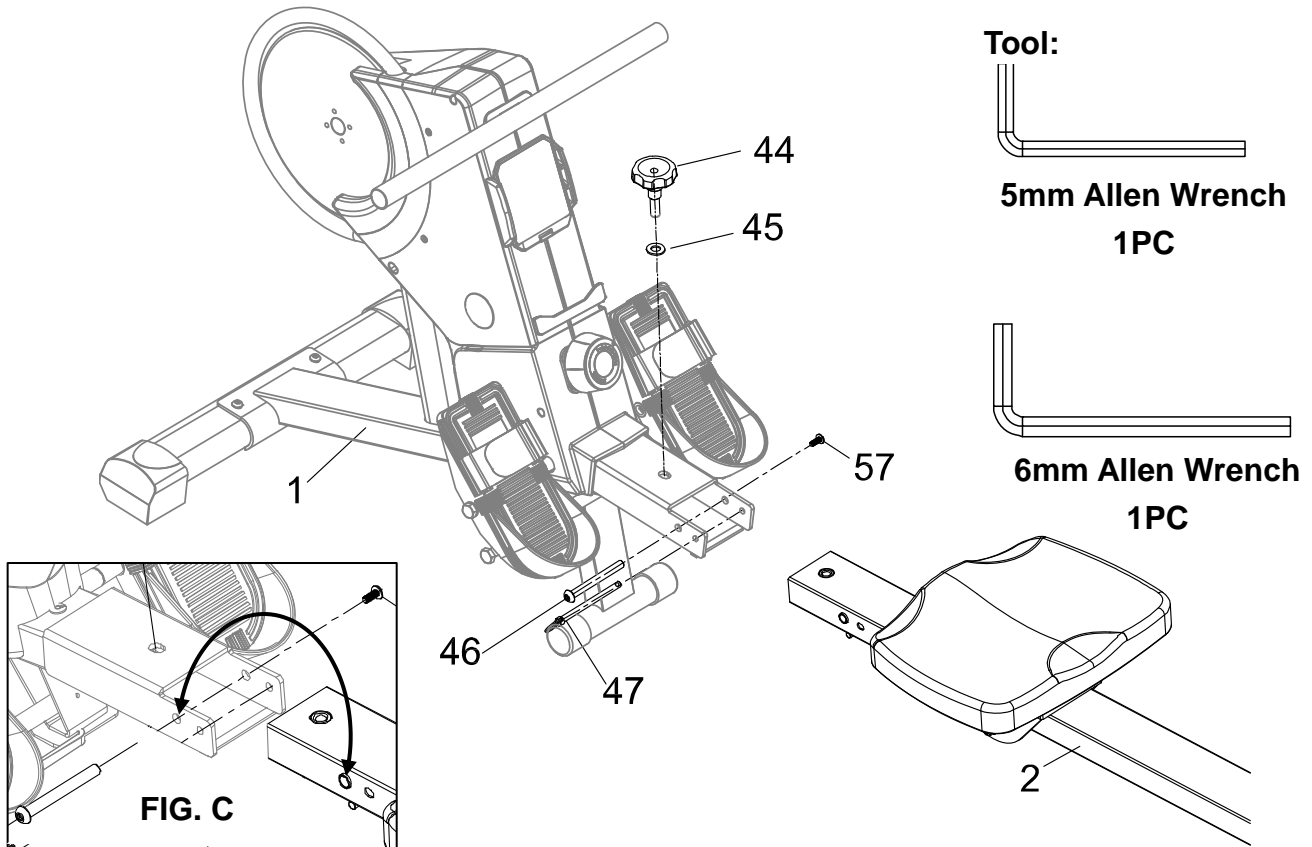

## Step 6

### 6A. Installing the Seat Sliding Tube

Slide the **Sliding Tube (2)** into the **Main Frame (1)**. Align the bolt holes shown in **FIG. C**, and insert one **Hex Bolt (46)**. Push the **Hex Bolt (46)** through the frame and attach one **Round Head Hex Bolt (57)**. Tighten using the **5mm Allen Wrench** and **6mm Allen Wrench** provided.

Insert the **Safety Pin (47)** to secure the **Main Frame (1)** and the **Sliding Tube (2)**.

Secure the **Main Frame (1)** and **Sliding Tube (2)** with one **Flat Washer (45)** and one **Round Knob (44)**.

### Hardware:

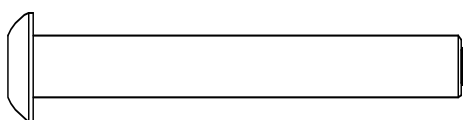

**(46) Hex Bolt**  
1PC

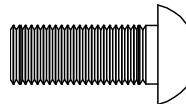

**(57) Round Head**  
**Hex Bolt**  
1PC

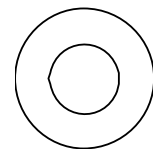

**(45) Flat Washer**  
1PC

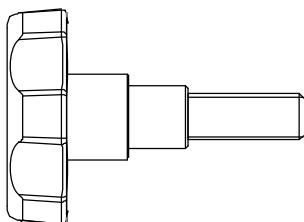

**(44) Round Knob**  
1PC

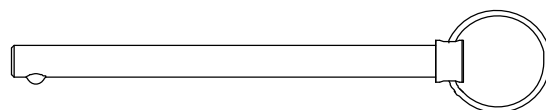

**(47) Safety Pin**  
1PC

# ASSEMBLY

Tool:

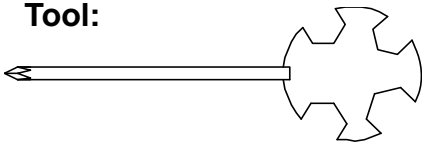

Multi-Hex Tool with Phillips  
Screwdriver 1PC

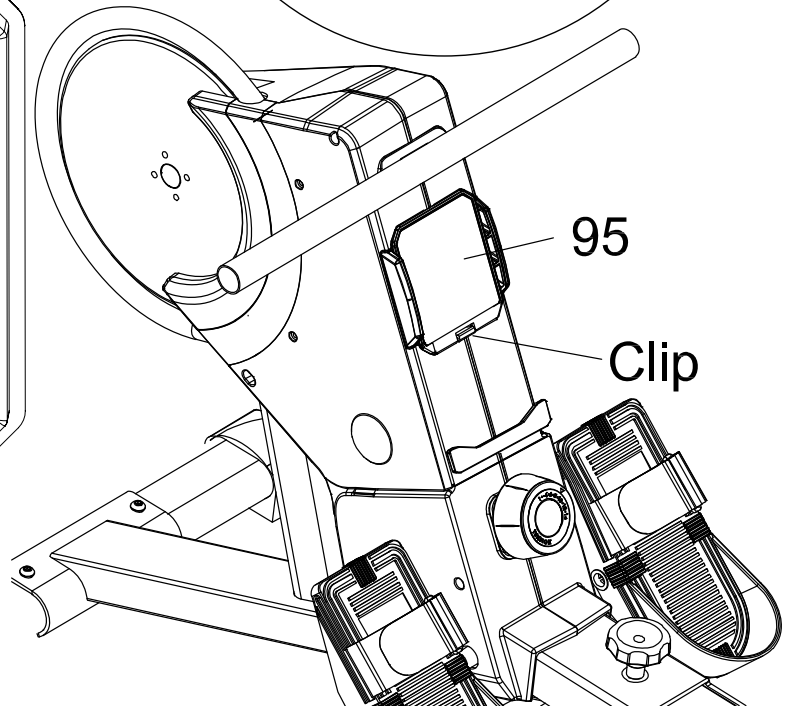
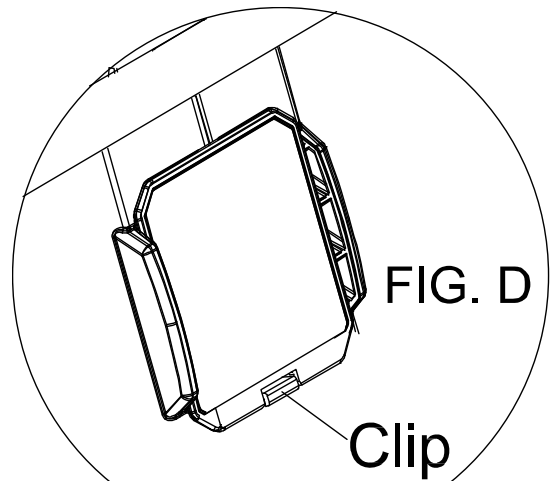
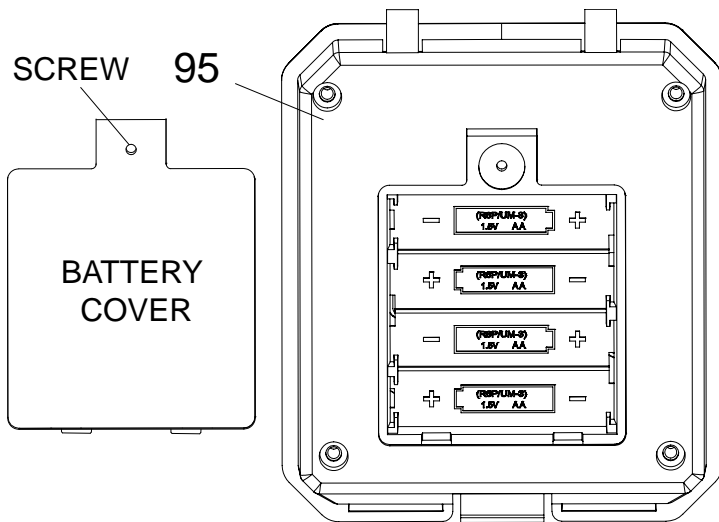

## Step 7

### 7A. Installing the Console Batteries

Lifting up on the **CLIP** shown in **FIG. D** and gently pulling the **Console (95)** out. **BE CAREFUL** when pulling the console out, there are **three wires** attached to the backside. Disconnect the wires to make installing the batteries easy.

Using the **Multi-Hex Tool with Phillips Screwdriver** remove the **SCREW** from the **BATTERY COVER** to open the **Console (95)**. Place 4 AA batteries into the console with the positive and negative poles as labeled.

Reattach the battery cover and replace the console back into the rowing machine. Make sure the three wires are connected to the console before replacing the console. If any one of them is not connected, the console will not function correctly.

Note: This product can only be powered by 4 AA batteries.

Note: Do not mix old and new batteries. Replace all the batteries at the same time.

# CONSOLE



## USING THE CONSOLE

**Power On:** The console will turn on when the user starts rowing or presses a button.

**Power Off:** The console will automatically turn off after 20 minutes of inactivity.

**Reset:** Press and hold the STOP button for 3 seconds to reset the console.

**Pause:** Press the START button during a workout.

**Start Workout:** Press the START button for the console to begin tracking your workout.

**End Workout:** Press the STOP button to end a workout and show the workout results.

## WORKOUT DISPLAY

- **STROKES:** Will track the total number of strokes/pulls during the workout, up to a total of 9999.
  - This display will shift between SPM and STROKES every 4 seconds.
  - See the indicator arrow for the value currently being displayed.
- **CAL:** Will track the number of calories burned during the workout, up to a value of 999.
  - This is only an estimated value base on an average user.
- **TIME:** Will track the total workout time, up to a maximum value of 99:59 minutes.
- **SPM:** Will display the average number of strokes you are pulling in a minute based on the current workout pace.
  - This display will shift between SPM and STROKES every 4 seconds.
  - See the indicator arrow for the value currently being displayed.
- **METERS:** Will track your distance in meters, up to a maximum value of 9999 meters. The console will end the workout when 9999 meters is reached.
- **SPLIT:** Will display the average time it takes to travel 500 meters based on the current workout pace.
- **WATTS:** Will display the current workout effort in the form of Watts.
  - The Watts value is dependent on the length of the pull, the pace of the workout, and the resistance level.
  - The resistance level control knob is wired to the console to track the effort of the workout based on the resistance level set on the console.
  - At the end of the workout, this section will show the MAX watt values reached during the workout.
- : The **MyCloudFitness** symbol turns on when the Bluetooth antenna is connected to the APP.
  - If the symbol is flashing, the connection to the app has not been established.
  - If a connection cannot be made, shut down and restart the APP.

## SETTING WORKOUT GOALS

- Press the GOALS button before starting a workout to set a METERS, TIME, CALORIES, or STROKES GOAL.
- Press the GOALS button until the desired GOAL option is flashing.
- Use the UP and DOWN buttons to adjust the GOAL value.
- Press the ENTER button to confirm the GOAL value.
- Press the START button to begin the workout.
- The console will beep 3 times when the GOAL is achieved.

## ADJUSTING THE RESISTANCE LEVEL

- Turn the knob clockwise to increase the resistance level of the workout.
- Turn the knob Counter-clockwise to decrease the resistance level of the workout.
- The console will adjust the distance per stroke, watt output, and calorie burn based on resistance level setting.

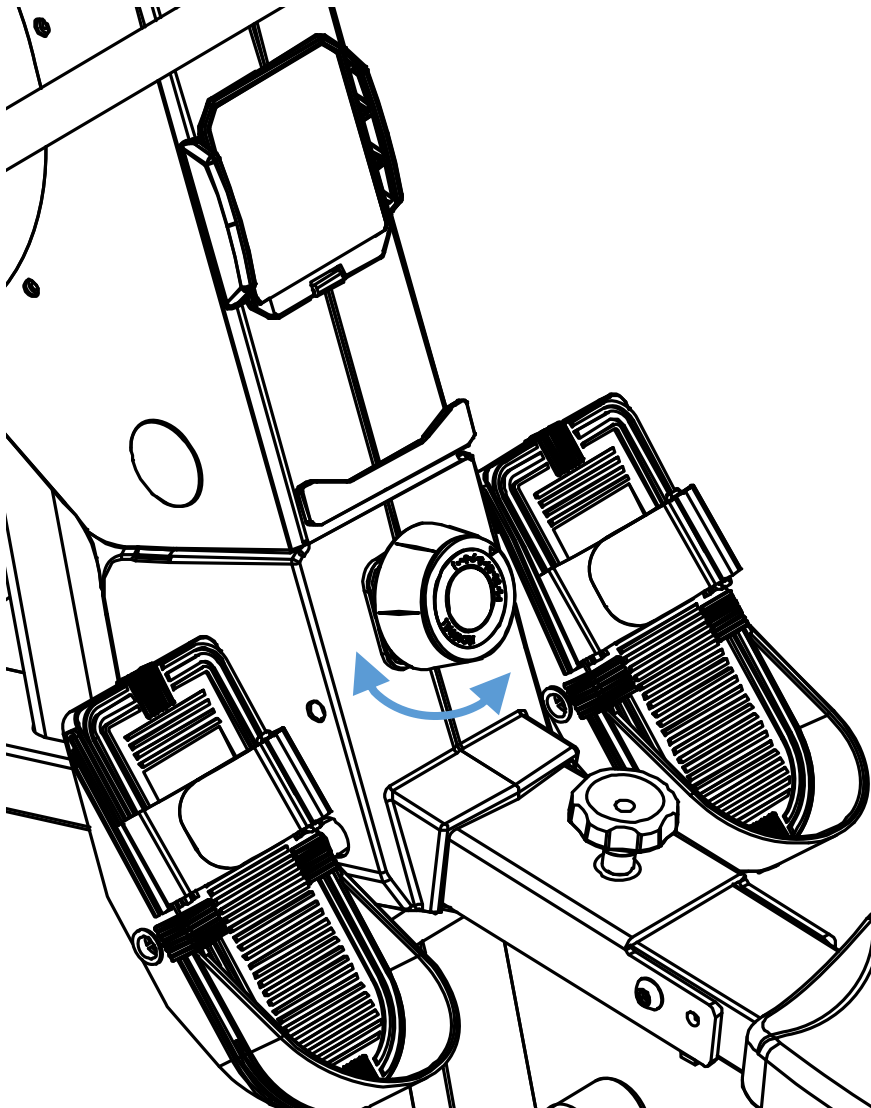

## ADJUSTMENTS & TRANSPORTING

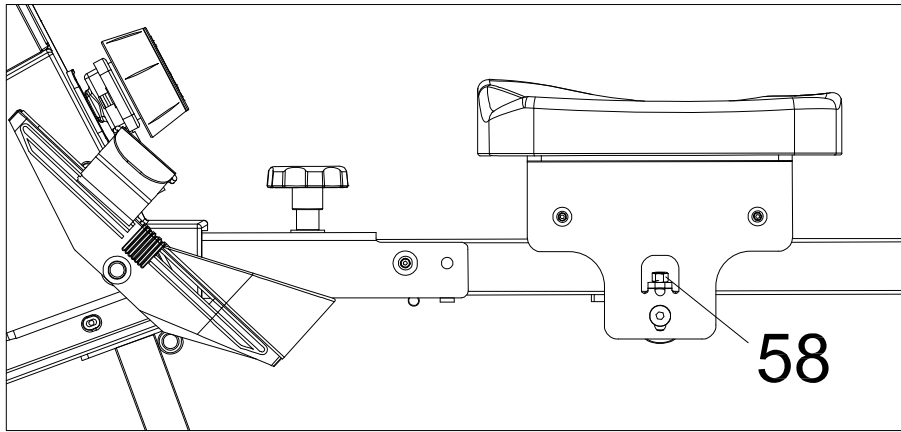

- If the seat does not slide easily, or the seat shakes too much, adjust the **Nylon Nut (58)** on both sides of the seat.

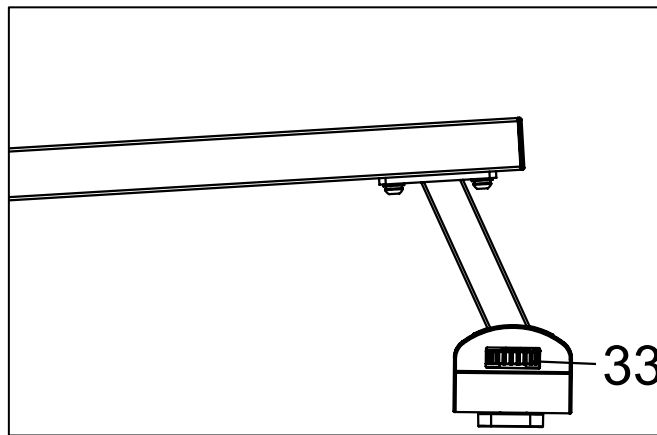

- If the frame is shaking while in use, extend the foot on the **Rear Stabilizer End Caps (33)** to balance the frame. The extending foot will also improve the grip between the endcaps and the floor.

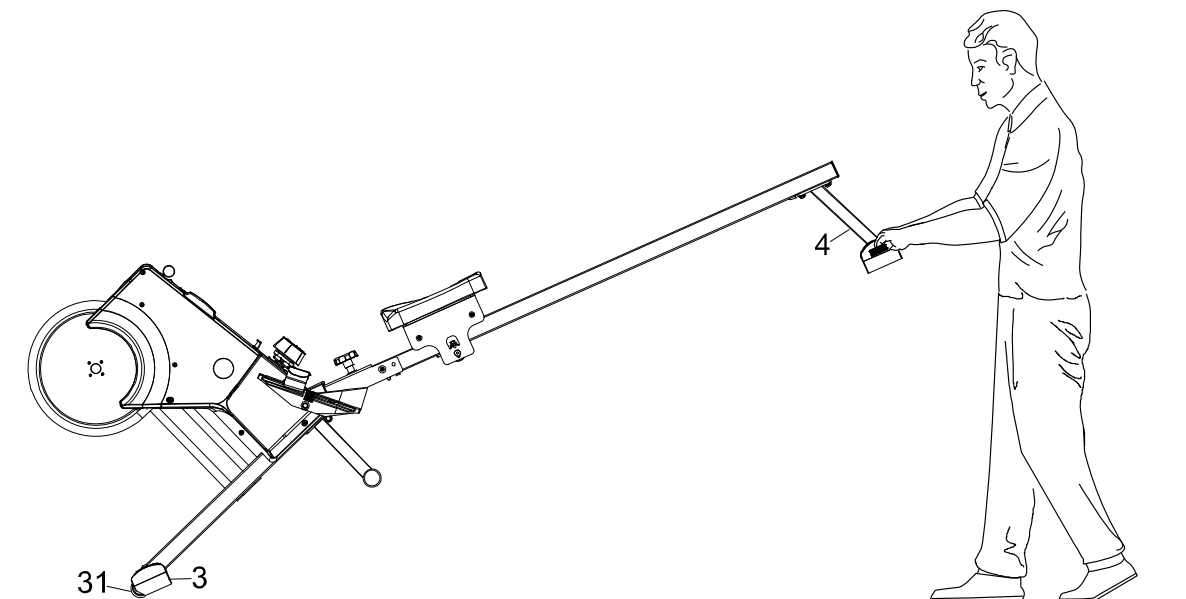

- Hold the **Rear Stabilizer (4)** and pull the machine until the wheels on the **Front Stabilizer (3)** make contact with the floor. Push or pull the unit to the desired location, then gently lower the **Rear Stabilizer (4)** to the ground.



## STORAGE

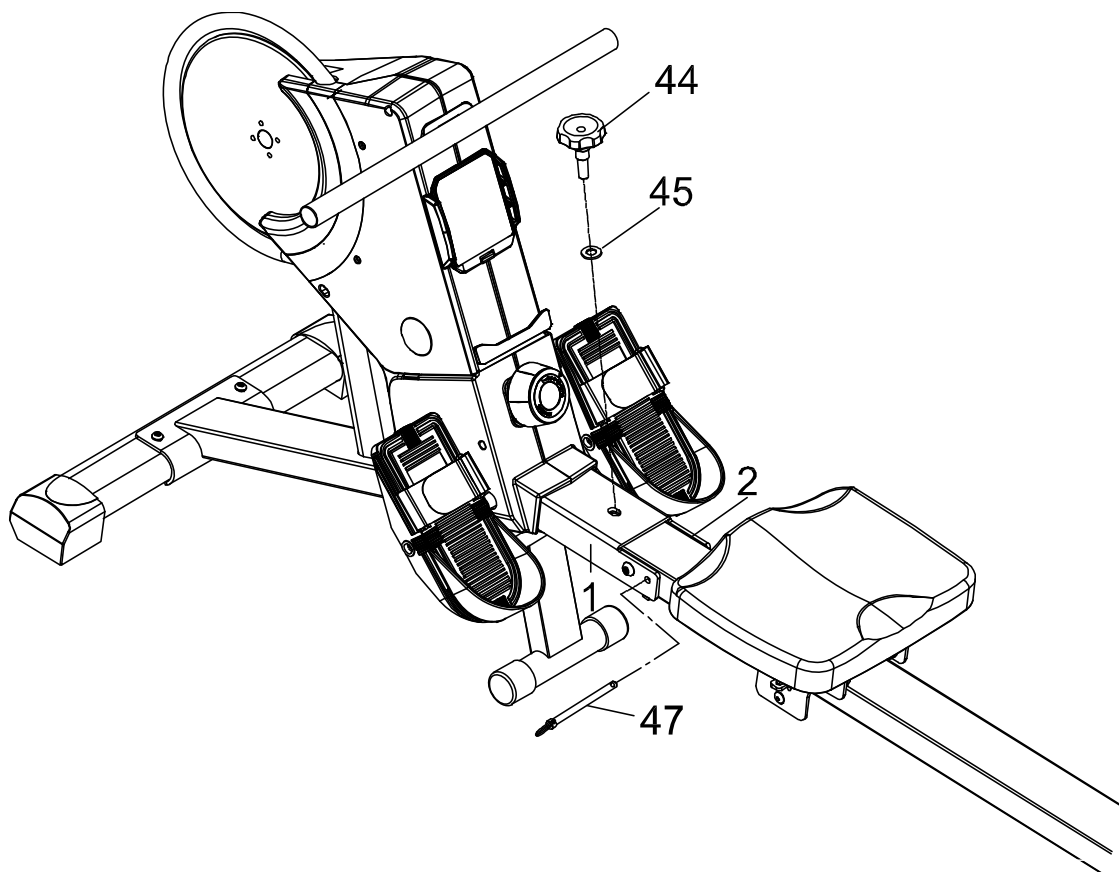

- Remove the **Safety Pin (47)**, the **Round Knob (44)** and **Flat Washer (45)** from the **Sliding Tube (2)** and the **Main Frame (1)**.

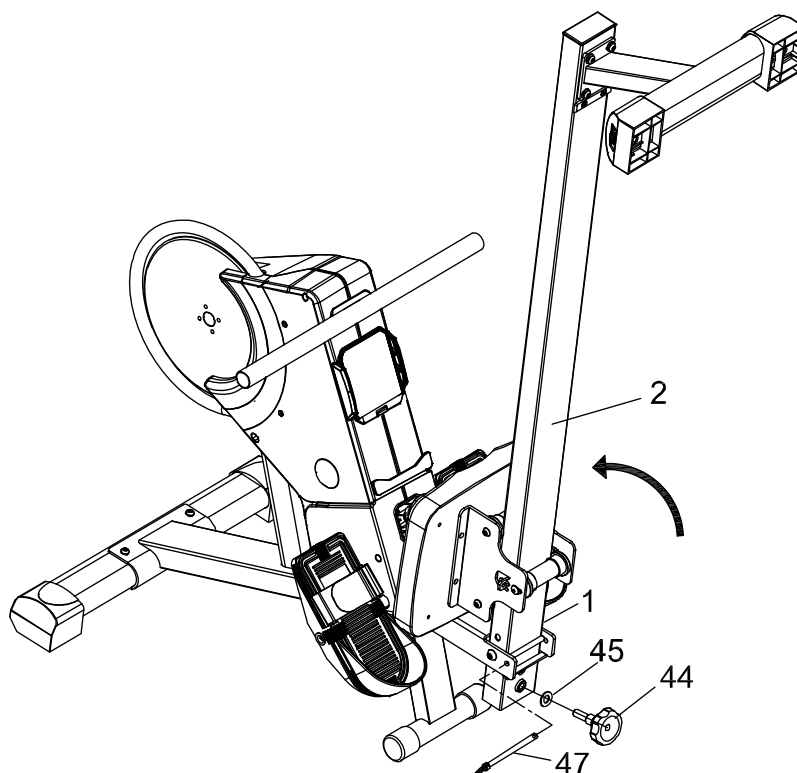

- Lift up the **Sliding Tube (2)** and insert the **Safety Pin (47)** to lock the **Sliding Tube (2)** in the upright position. Insert the **Round Knob (44)** and **Flat Washer (45)** back into the underside of the **Sliding Tube (2)**.
- ALWAYS Store the machine in a clean and dry environment away from pets and children.



### CLEANING / MAINTENANCE

- The rower can be cleaned with a soft clean damp cloth. Do not use abrasives or solvents on the plastic parts.
- Please wipe your perspiration off the rower after each use. Be careful not to get excessive moisture on the computer display panel as this might cause an electrical hazard or the electronics to fail.
- Please keep the computer console and the rower, out of direct sunlight to prevent screen damage.
- Please inspect all assembly bolts, nuts, screws, and pedals on the machine for proper tightness every week.

### TROUBLESHOOTING

- **PROBLEM:** There is no display on the computer console.
  - **SOLUTION:** Remove the console and verify that the wire at the rear of the console is properly connected to the wires that come from the frame.
  - **SOLUTION:** Check that the batteries are correctly inserted and the battery springs are in proper contact with the batteries.
  - **SOLUTION:** The batteries in the computer console may be dead. Replace the dead batteries with new batteries. Do NOT mix old and new batteries.
- **PROBLEM:** The rower makes a squeaking noise when in use.
  - **SOLUTION:** The bolts may be loose on the equipment. Please inspect all of the nuts, bolts, screws and tighten any loose Hardware.

# WARRANTY

## **MANUFACTURER'S LIMITED WARRANTY**

Paradigm Health & Wellness warrants to the original purchaser that this product is free from defects in material and workmanship when used for the purpose intended, under the conditions that it has been installed and operated in accordance with Paradigm's Owner's Manual. Paradigm's obligation under this warranty applies to the following:

<b><u>COMPONENT</u></b>	<b><u>LENGTH OF WARRANTY</u></b>
Structural Frame	3 years For Home Use Only
All Other Components	180 days For Home Use Only

### **Exclusions from Warranty Coverage:**

Paradigm does not warrant against and is not responsible for, and no implied warranty shall be deemed to cover, any product failure, product malfunction, or damages attributable to:

1. Improper installation and/or failure to abide by Paradigm's installation guidelines;
2. Use of this product beyond normal home use, or in an application for which it was not designed;
3. Cosmetic items such as scratches, dents or discolorations;
4. Damage caused by normal wear and tear, vandalism, accidental or by animals;
5. Any act of Nature (such as fire, flooding, snow, ice, hurricane, earthquake, lightning or other natural disaster), environmental condition (such as air pollution, mold, mildew, etc.), or staining from foreign substances (such as dirt, grease, oil, etc.);
6. Normal weathering due to exposure to sunlight, weather and atmosphere which can cause colored surfaces to, among other things, flake, chalk, accumulate dirt or stains.
7. Improper operation, alteration, handling, storage, abuse or neglect of the products.

**Paradigm, using its sole discretion, will either repair or replace free of charge any part(s) proven to be defective under normal home use. Any repair or replacement shall provide no new warranty coverage, but shall retain only the remaining portion of the original product's warranty. This warranty is offered only to the original purchaser and is not transferable. Proof of original purchase is required.**

### **Ordering Replacement Parts**

Replacement parts can be ordered by emailing our customer service department:

**Service@paradigmhw.com**

Open Monday thru Friday 8:00 AM - 5:00 PM (PST).

When ordering replacement parts please have the following information ready:

- 1. Owner's Manual**
- 2. Model Number**
- 3. Description of Parts**
- 4. Part Number**
- 5. Date of Purchase**

## PARTS REQUEST FORM

**Paradigm Health & Wellness, Inc.**

EMAIL THIS FORM WITH YOUR RECEIPT OF PURCHASE TO

**[Service@paradigmhw.com](mailto:Service@paradigmhw.com)**

NAME: \_\_\_\_\_

ADDRESS: \_\_\_\_\_

CITY: \_\_\_\_\_ STATE: \_\_\_\_\_ ZIP: \_\_\_\_\_

TELEPHONE: (Day) \_\_\_\_\_

(Night) \_\_\_\_\_

SERIAL#: \_\_\_\_\_

MODEL#: \_\_\_\_\_

PURCHASE DATE: \_\_\_\_\_

PLACE OF PURCHASE: \_\_\_\_\_

PART #	DESCRIPTION	QTY

***“YOUR ORDER WILL BE PROCESSED WITHIN 3 BUSINESS DAYS”***

***\*This form can also be faxed to #: 626-810-2166***