

# EXERPEUTIC 275SL Inversion Table with 'SURELOCK' Safety Ratchet Ankle Locking System

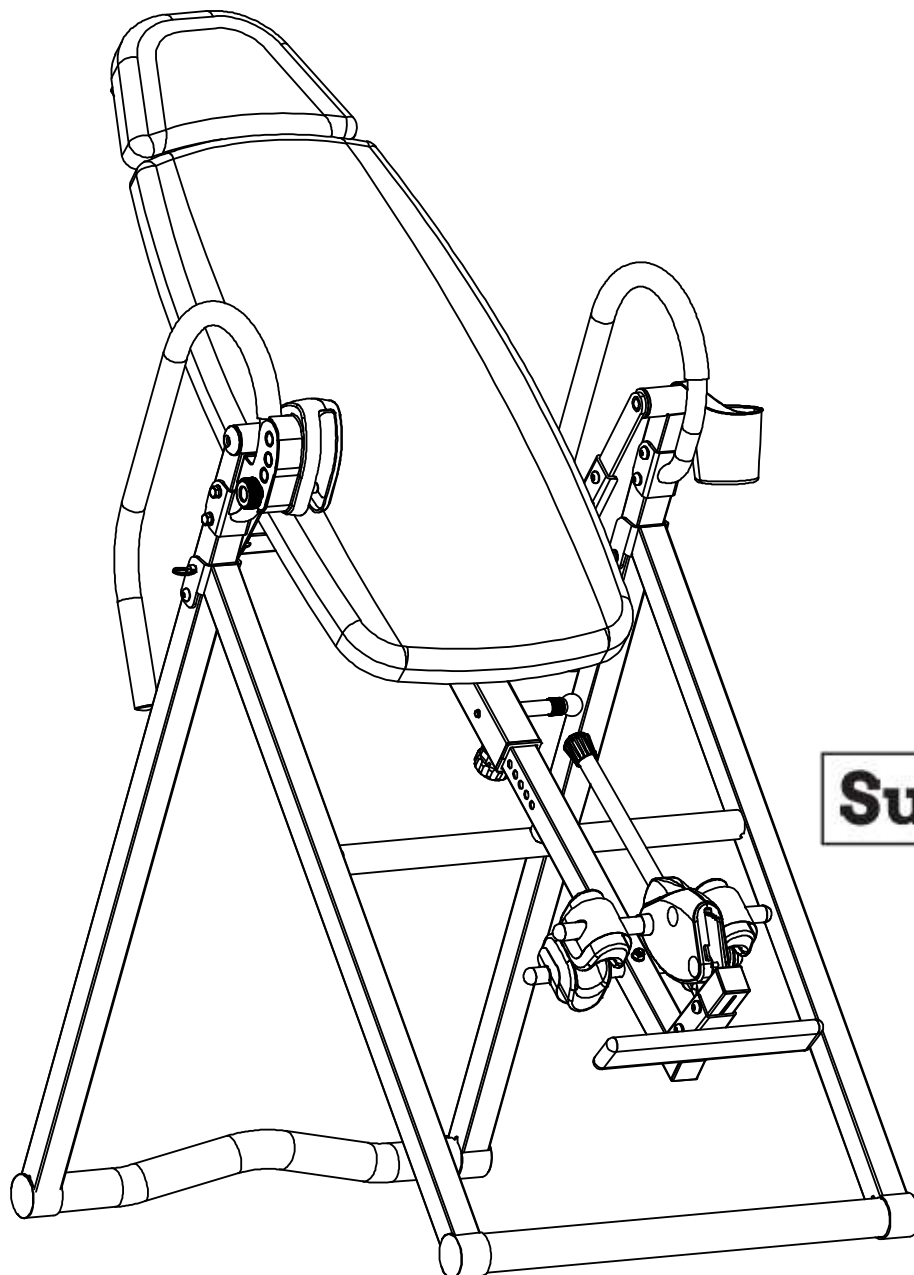

**SureLock®**

The specifications of this product may vary from this photo and are subject to change without notice.



**PLEASE DO NOT RETURN THIS PRODUCT TO THE STORE.**

**STOP. Contact customer service if you have any questions regarding assembly or proper operation of the machine.**

**Email us at:**  
**[Service@paradigmhw.com](mailto:Service@paradigmhw.com)**

**Or call us at:**  
**1-844-641-7921**  
**Hours:**  
**8:00 am to 5:00 pm (PST)**  
**Monday thru Friday**

# TABLE OF CONTENT

|                                  |    |
|----------------------------------|----|
| SERVICE-----                     | 2  |
| IMPORTANT SAFETY GUIDELINES----- | 3  |
| LABEL PLACEMENT-----             | 5  |
| OVERVIEW DRAWING-----            | 6  |
| PARTS LIST-----                  | 7  |
| HARDWARE & PARTS PACK-----       | 9  |
| ASSEMBLY-----                    | 10 |
| OPERATION & ADJUSTMENTS-----     | 21 |
| STORAGE-----                     | 28 |
| WARRANTY-----                    | 29 |
| PARTS REQUEST FORM-----          | 30 |

# SERVICE

## IMPORTANT: FOR NORTH AMERICA ONLY

For damaged or defective product, questions, replacement parts or any other service support, please contact our customer service department by the below methods:

**For The Best Service, please Email:**  
**service@paradigmhw.com**

Response Time: 1-2 Business Days

Emailing us with the information above will be the best method to receive a response during peak business hours

**Website:**  
**www.paradigmhw.com**

Toll-Free:

1-844-641-7921

**(8:00 AM - 5:00 PM Pacific Standard Time, Monday thru Friday)**

Response time may vary via calling

Please have the following information ready when requesting for service:

- Your name
- Phone number
- Model number
- Serial number
- Part number
- Proof of Purchase

For damaged or defective product please contact our customer service before returning to the store.

Paradigm Health & Wellness, Inc.

1189 Jellick Ave.

City of Industry, CA 91748, USA

# IMPORTANT SAFETY GUIDELINES

Read all instructions before using the Inversion Table. When using an Inversion table, basic precautions should always be followed, including the following:

## **WARNING - To reduce the risk of injury to persons:**

1. Make sure your equipment is correctly assembled before you use it.
2. Be sure all screws, nuts, and bolts are tightened prior to use.
3. Only one person should use the equipment at a time.
4. Never operate this equipment if it is damaged, If it is not working properly, has been dropped, or damaged. If a problem is encountered contact Customer Service before using the equipment again.
5. Always use this equipment on a clear and level surface.
6. For Household Use Only.
7. Do not use outdoors or near water.
8. Use the inversion table only for its intended use as described in this manual. Do not use attachment not recommended by the manufacturer.
9. Do not wear loose clothing when using the equipment.
10. Keep all hands and feet away from any moving parts.
11. Never drop or insert any object into any opening.
12. Always wear shoes when using the inversion table.
13. Close supervision is necessary when the inversion table is used near children, or by or near invalids or disabled persons.
14. Listen to your body. It is recommended that you rotate up and down slowly. Dizziness might occur if you come up too fast.
15. If at any time you feel faint, light-headed, or dizziness while operating the equipment, stop exercising immediately. You should also stop exercising if you are experiencing pain or any discomfort.
16. "This appliance is not intended for use by persons with reduced physical, sensory or mental capabilities, or lack of experience and knowledge, unless they have been given supervision or instruction concerning use of the appliance by a person responsible for their safety. Keep children under the age of 13 away from this machine."
17. Wait 2 hours after eating before using the inversion table. If you start feeling nauseous, return to the upright position slowly.
18. For any problems contact customer service. Servicing should be performed by an authorized service representative. Our contact number is on the service page.
19. **WARNING:** - Risk of Personal Injury - Consult with your personal physician to see if inversion equipment is appropriate for you. This is especially important for people with pre-existing health problems. Do not use this equipment without your physician's approval.
20. **WARNING:** - Risk of Personal Injury – Do not allow children to use this machine.
21. **WARNING:** - Risk of Personal Injury - Keep children under the age of 13 away from the machine while in use.
22. **WARNING:** - Risk of Personal Injury – Keep body parts, hair, loose clothing, and jewelry clear of all moving parts.
23. **WARNING:** - Risk of Personal Injury - Tilt-back slowly when inverting. Failure to comply could result in serious bodily injury.

# IMPORTANT SAFETY GUIDELINES

24. **WARNING:** - Risk of Personal Injury - Do not attempt to service the unit yourself. Discontinue use and contact customer service.
25. **WARNING:** - To Reduce The Risk Of Personal Injury - Read And Understand All The Instructions Before Using The Inversion Table.
26. **WARNING: CANCER AND REPRODUCTIVE HARM--**[WWW.P65WARNINGS.CA.GOV](http://WWW.P65WARNINGS.CA.GOV).

**Do not use this equipment if you have any of the following conditions or ailments:**

- Pregnancy
- Extreme obesity
- Middle ear infection
- Hiatus hernia or Ventral hernia
- Glaucoma, retinal detachment or conjunctivitis
- Use of anticoagulants including Aspirin in high doses.
- Spinal injury, Cerebral Sclerosis, or acutely swollen joints
- Heart or circulatory disorders for which you are being treated
- High blood pressure, Hypertension, Recent stroke or Transient Ischemic attack
- Bone weaknesses including Osteoporosis, Unhealed fractures, Modular pins, or surgically implanted orthopedic supports.

**Do not exceed the maximum rated weight (load) and maximum rated user height:**

The Maximum Weight Capacity for this product is 300lbs / 136kgs.

The Maximum Height Capacity for this product is 6 feet 6 inches / 198cm.

**Retain this owner's manual and keep the original purchase receipt for future reference.**

## SAVE THESE GUIDELINE



The product weighs more than 44 lbs. It is heavily recommended that at least 2 persons assemble.

# LABEL PLACEMENT

**⚠ WARNING**  
**WARNING: CANCER AND REPRODUCTIVE HARM -- WWW.P65WARNINGS.CA.GOV.**

▶ To avoid serious injury, hold on to handle bars and invert slowly.  
 Pour éviter des blessures graves, bien tenir les poignées de sécurité et procéder à l'inversion lentement.  
 Para evitar lesiones graves, sostenga los manubrios y ponga al revés lentamente.

**EXERPEUTIC**  
 For customer assistance,  
 Monday - Friday:  
 Pour le service à la clientèle  
 composer le, lundi à vendredi:  
 Para servicios al cliente,  
 llame al, lunes a viernes:  
**1-844-641-7921**  
 8 am - 5 pm PST



**UL US LISTED**  
 Paradigm Health & Wellness  
 Inversion Table, Tabla de inversión,  
 Tabla de inversión  
 MODEL: 4530 DATE: XX/XX  
**FOR HOUSEHOLD USE ONLY**  
 POUR USAGE DOMESTIQUE SEULEMENT  
 PARA USO DOMÉSTICO SOLAMENTE  
 NO-E238026  
 11VU

**⚠ ADVERTENCIA**  
**Capacidad de altura y peso máximo para este producto son 198 cm y 136 kg.**

**⚠** Feet must be secured properly before use.  
 Les pieds doivent être proprement serrés avant utilisation.  
 Se deben asegurar adecuadamente los pies antes de usar.



Feet Bracket Tether must be in slot - refer to the Manual.  
 El Diente del Soporte del Talón debe estar en ranura, consulte el Manual.  
 La Dent du Support du Talon doit être en emplacement, voir le Manuel.

**⚠ ADVERTENCIA**  
 La support de la cheville doit être serré autour des chevilles et le dispositif doit être engagé avant d'utiliser la table de renversement.

**⚠ AVERTISSEMENT**  
 El soporte de tobillo debe ser ajustado alrededor de los tobillos, y el trinquete debe estar trabado antes de usar la tabla de inversión.

**⚠ WARNING:**  
 The ankle holder must snug around ankles, and the ratchet must be locked before using the inversion table.

**⚠ WARNING**  
**RISK OF INJURY - KEEP CHILDREN UNDER THE AGE OF 13 AWAY FROM THIS MACHINE AT ALL TIMES.**  
**⚠ AVERTISSEMENT**  
**RISQUE DE BLESSURE - GARDEZ LES ENFANTS DE MOINS DE 13 ANS LOIN DE LA MACHINE.**

**⚠ WARNING**  
 WARNING - TO REDUCE THE RISK OF PERSONAL INJURY, READ AND UNDERSTAND ALL THE INSTRUCTIONS BEFORE USING THE INVERSION TABLE  
 - DO NOT ALLOW CHILDREN TO USE THIS MACHINE  
 - KEEP CHILDREN AWAY FROM MACHINE WHILE IN USE  
 - KEEP BODY PARTS, HAIR, LOOSE CLOTHES AND JEWELRY CLEAR OF ALL MOVING PARTS  
 - ENSURE ALL NUTS, SCREWS, BOLTS AND FASTENERS ARE TIGHT BEFORE EVERY USE  
 - REVIEW ALL WARNING AND INSTRUCTIONS BEFORE ASSEMBLY AND USAGE

**⚠ ATTENTION**  
 AVERTISSEMENT - POUR RÉDUIRE LE RISQUE DE BLESSURE PERSONNELLE, LIRE ET COMPRENDRE TOUTES LES INSTRUCTIONS AVANT D'UTILISER LA TABLE D'INVERSION  
 - NE PAS PERMETTRE AUX ENFANTS D'UTILISER CETTE MACHINE  
 - TENIR LES ENFANTS À L'ÉCART DE LA MACHINE PENDANT L'UTILISATION  
 - GARDER LES PIÈCES DU CORPS, LES CHEVEUX, LES VÊTEMENTS LIBRES ET LES BIJOUX CLAIRS DE TOUTES LES PIÈCES EN MOUVEMENT  
 - ASSURER-VOUS QUE TOUS LES ÉCROUS, VIS, BOULONS ET ATTACHES SONT SERRÉS AVANT CHAQUE UTILISATION  
 - REVOIR TOUTS LES AVERTISSEMENTS ET INSTRUCTIONS AVANT L'ASSEMBLAGE ET L'UTILISATION

**⚠ WARNING / AVERTISSEMENT**  
**Max. Weight: 300lbs. & Max. Height: 6'6"**  
**Le poids Maximum et hauteur pour ce produit est 136 kgs / 198 cm.**  
**⚠ ADVERTENCIA**  
**RIESGO DE LESIONES - NIÑO BAJO LA EDAD 13 MANTENER LEJOS DE ESTA MAQUINA EN TODO MOMENTO.**



# OVERVIEW DRAWING

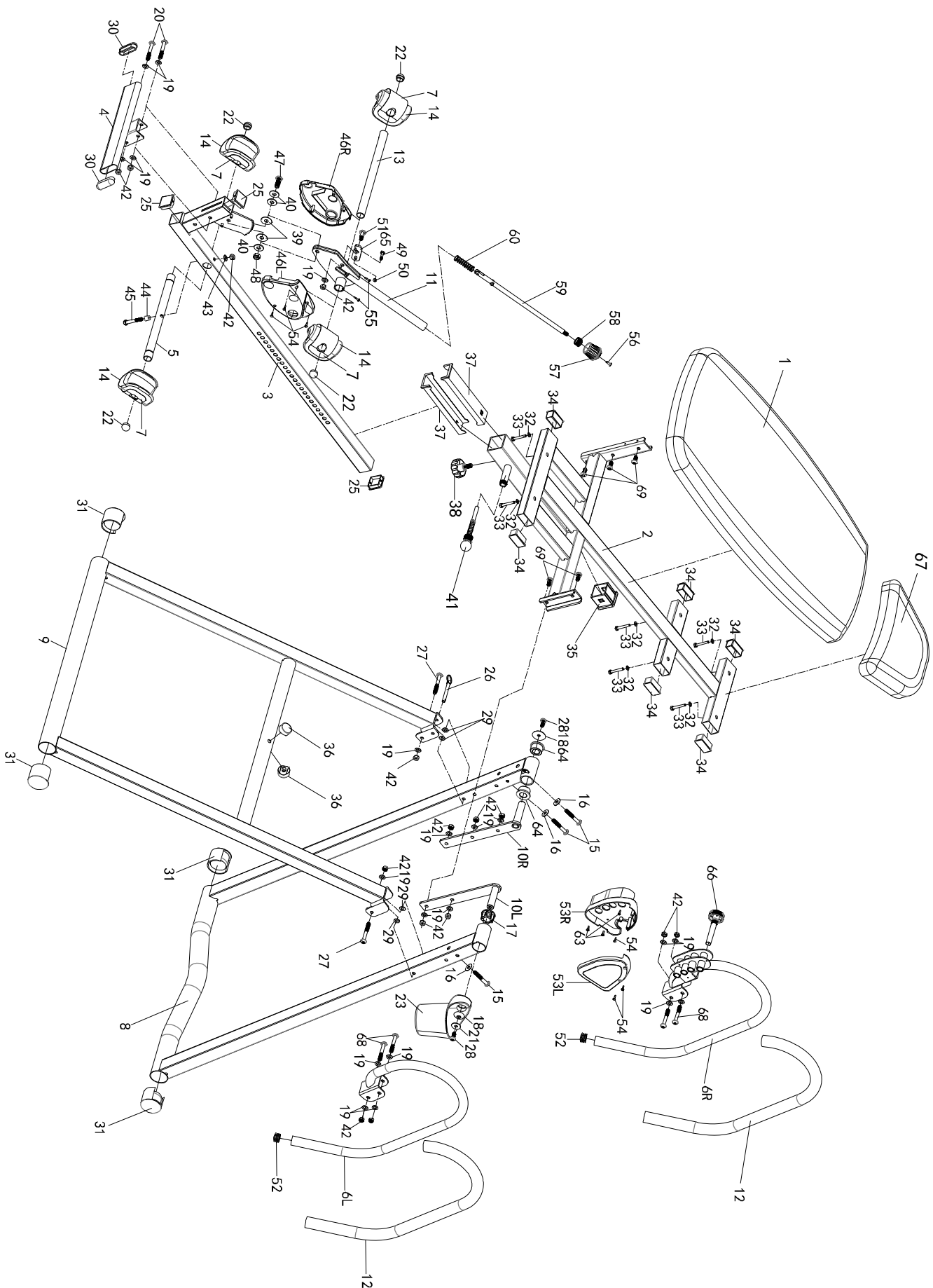



# PARTS LIST

| No. | Description               | Qty |
|-----|---------------------------|-----|
| 1   | Backrest                  | 1   |
| 2   | Backrest Frame            | 1   |
| 3   | Adjustable Boom           | 1   |
| 4   | Foot Bar                  | 1   |
| 5   | Rear Rod                  | 1   |
| 6L  | Left Handlebar            | 1   |
| 6R  | Right Handlebar           | 1   |
| 7   | Steel Heel Holder Bracket | 4   |
| 8   | Rear Frame                | 1   |
| 9   | Front Frame               | 1   |
| 10L | Left Pivot Arm            | 1   |
| 10R | Right Pivot Arm           | 1   |
| 11  | Adjustable Handle         | 1   |
| 12  | Handlebar Foam Grip       | 2   |
| 13  | Front Rod                 | 1   |
| 14  | Rubber Heel Holder        | 4   |
| 15  | Socket Hex Bolt M8x55mm   | 3   |
| 16  | Flat Washer Ø25xØ8.5x2    | 3   |
| 17  | Plastic Spacer            | 1   |
| 18  | Plastic Round End Cap     | 2   |
| 19  | Flat Washer Ø16xØ8.5x1.5  | 20  |
| 20  | Socket Hex Bolt M8x58mm   | 2   |
| 21  | Flat Washer Ø25xØ8.5x1.5  | 1   |
| 22  | Rod Cap                   | 4   |
| 23  | Cup Holder                | 1   |
| 25  | Square End Cap □38        | 3   |
| 26  | Safety Pin Ø8x63.5mm      | 1   |
| 27  | Socket Hex Bolt M8x65mm   | 2   |
| 28  | Socket Hex Bolt M8x20mm   | 2   |
| 29  | Plastic Washer            | 4   |
| 30  | Foot Bar Oval End Cap     | 2   |

| No. | Description                          | Qty |
|-----|--------------------------------------|-----|
| 31  | Foot Cap                             | 4   |
| 32  | Flat Washer Ø13xØ6.5x1.5             | 6   |
| 33  | Hex Bolt M6x40mm                     | 6   |
| 34  | Square End Cap                       | 6   |
| 35  | Upper Bed Frame End Cap              | 1   |
| 36  | Rubber Pad                           | 2   |
| 37  | Lower Bed Frame Bushing              | 2   |
| 38  | Knob                                 | 1   |
| 39  | Flat Washer Ø30xØ10.5x0.5            | 2   |
| 40  | Flat Washer Ø25xØ10.5x2.0            | 3   |
| 41  | Spring Knob                          | 1   |
| 42  | Nylon Nut M8                         | 15  |
| 43  | Flat Washer Ø16xØ8.5x2.0             | 1   |
| 44  | Metal Bushing                        | 1   |
| 45  | Hex Bolt M8x53mm                     | 1   |
| 46L | Left Plastic Cover                   | 1   |
| 46R | Right Plastic Cover                  | 1   |
| 47  | Socket Hex Bolt M10x30mm             | 1   |
| 48  | Nylon Nut M10                        | 1   |
| 49  | Hex Bolt M5                          | 1   |
| 50  | Nylon Nut M5                         | 1   |
| 51  | Hex Bolt M8                          | 1   |
| 52  | Handlebar Round End Cap Ø25          | 2   |
| 53L | Left Handlebar Cover                 | 1   |
| 53R | Right Handlebar Cover                | 1   |
| 54  | Self-Tapping Phillips Screw ST3.5x13 | 6   |
| 55  | Self-Tapping Phillips Screw ST4.0x16 | 2   |
| 56  | Phillips Screw M5x18mm               | 1   |
| 57  | Button                               | 1   |
| 58  | Handlebar Cap                        | 1   |
| 59  | Activation Rod                       | 1   |

## PARTS LIST

| No. | Description                             | Qty |
|-----|---|-----|
| 60  | Spring                                  | 1   |
| 63  | Self-Tapping Phillips Screw<br>ST3.5x13 | 3   |
| 64  | Plastic Spacer                          | 2   |
| 65  | Latch                                   | 1   |

| No. | Description             | Qty |
|-----|-------------------------|-----|
| 66  | Adjustable Knob         | 1   |
| 67  | Head Cushion            | 1   |
| 68  | Socket Hex Bolt M8x60mm | 4   |
| 69  | Socket Hex Bolt M8x23mm | 5   |

## 4530-Hardware Pack

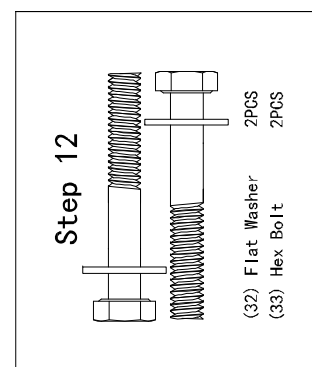
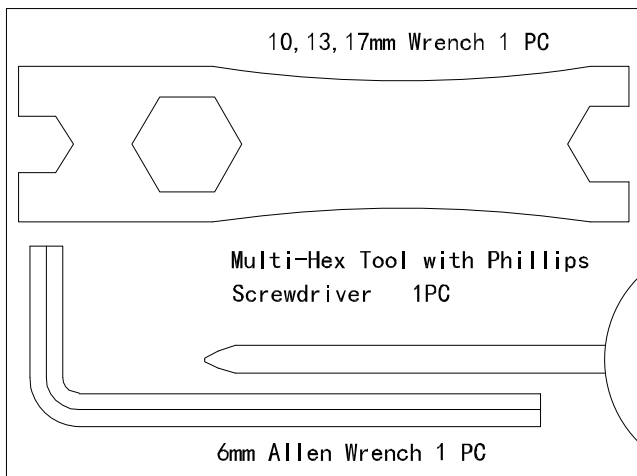
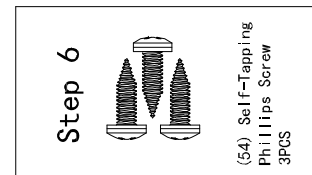
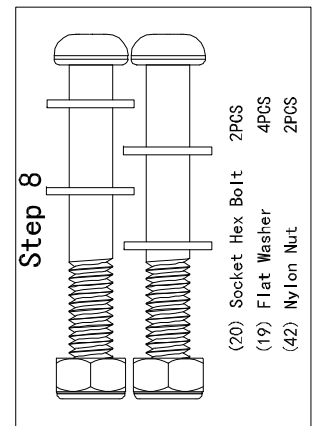
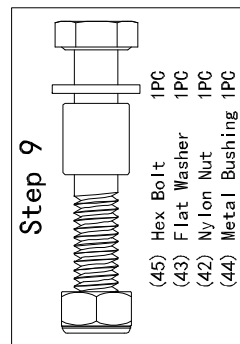
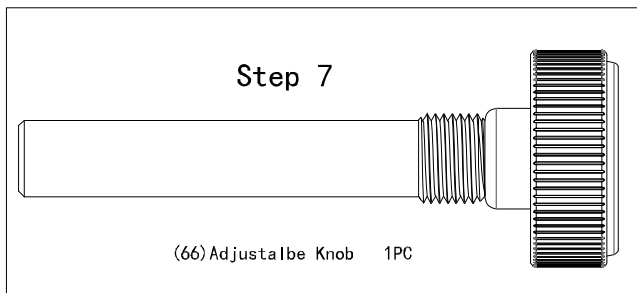
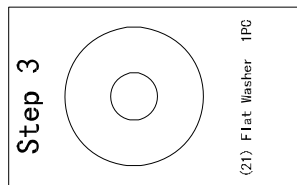
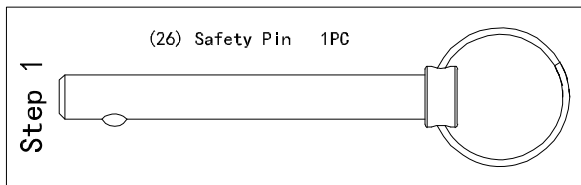
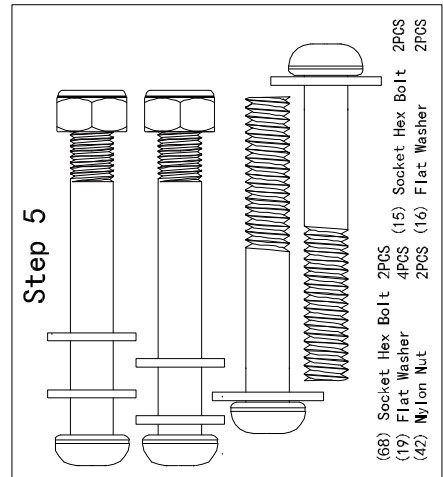
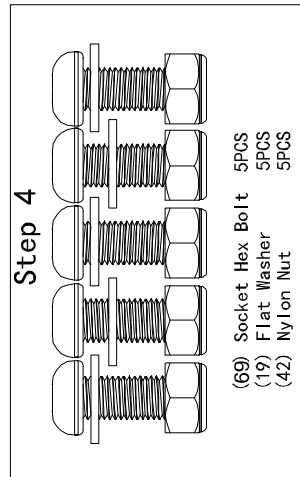
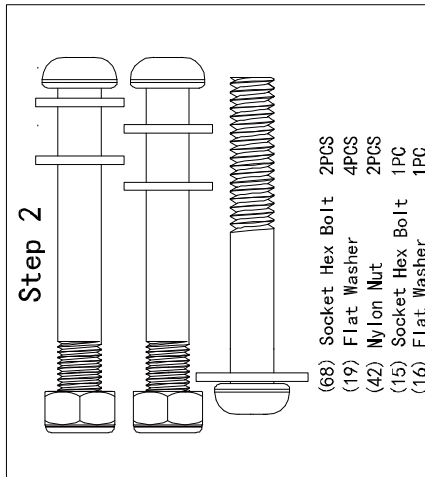

# ASSEMBLY



This product weighs more than 44lbs/20kgs and should be assembled and moved by two or more people.

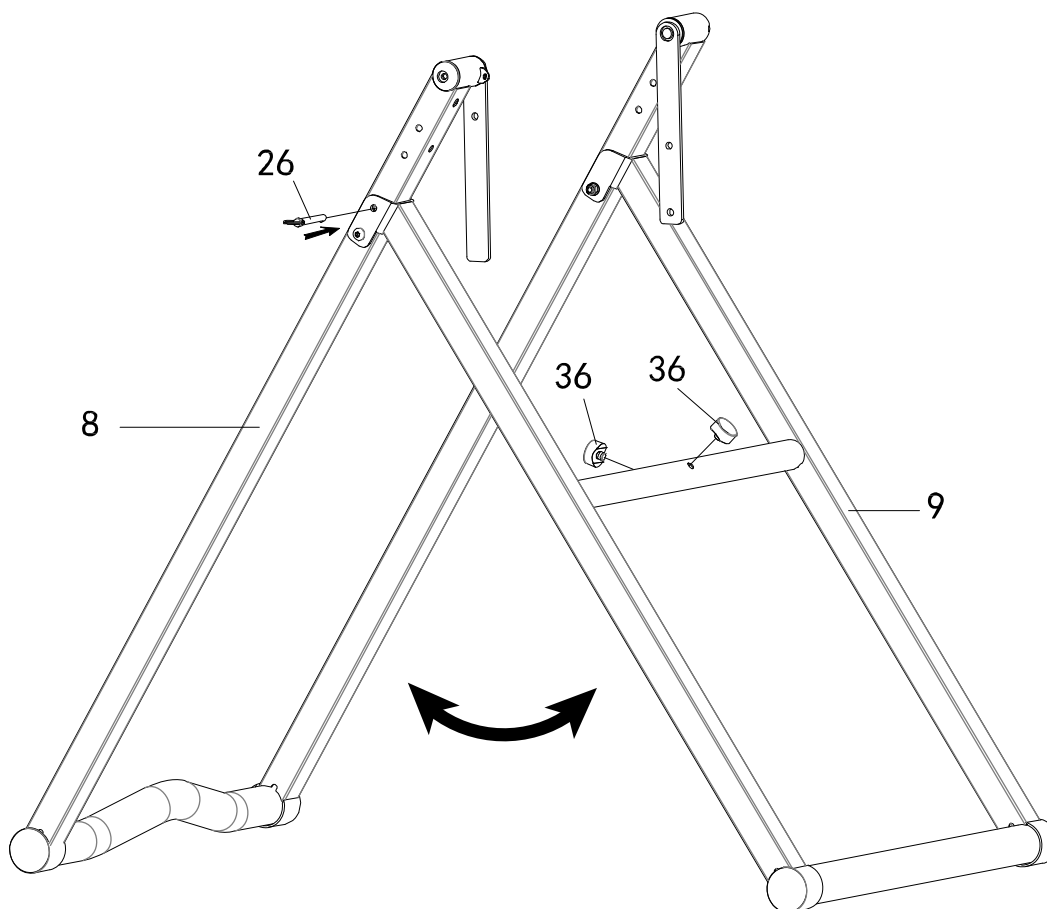

## Step 1

### Setting Up the Frame:

**1A.** Stand the frame up by pulling the **Front** and **Rear Frames (9, 8)** as far apart from each other as possible. Then insert the **Safety Pin (26)** into the hole on the right side of the frame to lock the **Front** and **Rear Frames (9, 8)** together.

**1B.** Attach the two **Rubber Pads (36)** onto the Cross beam of the **Front Frame (9)**.

### Hardware:

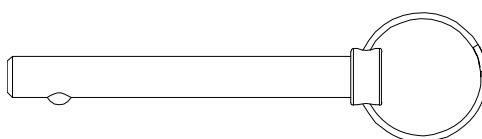

**(26) Safety Pin 1PC**

# ASSEMBLY

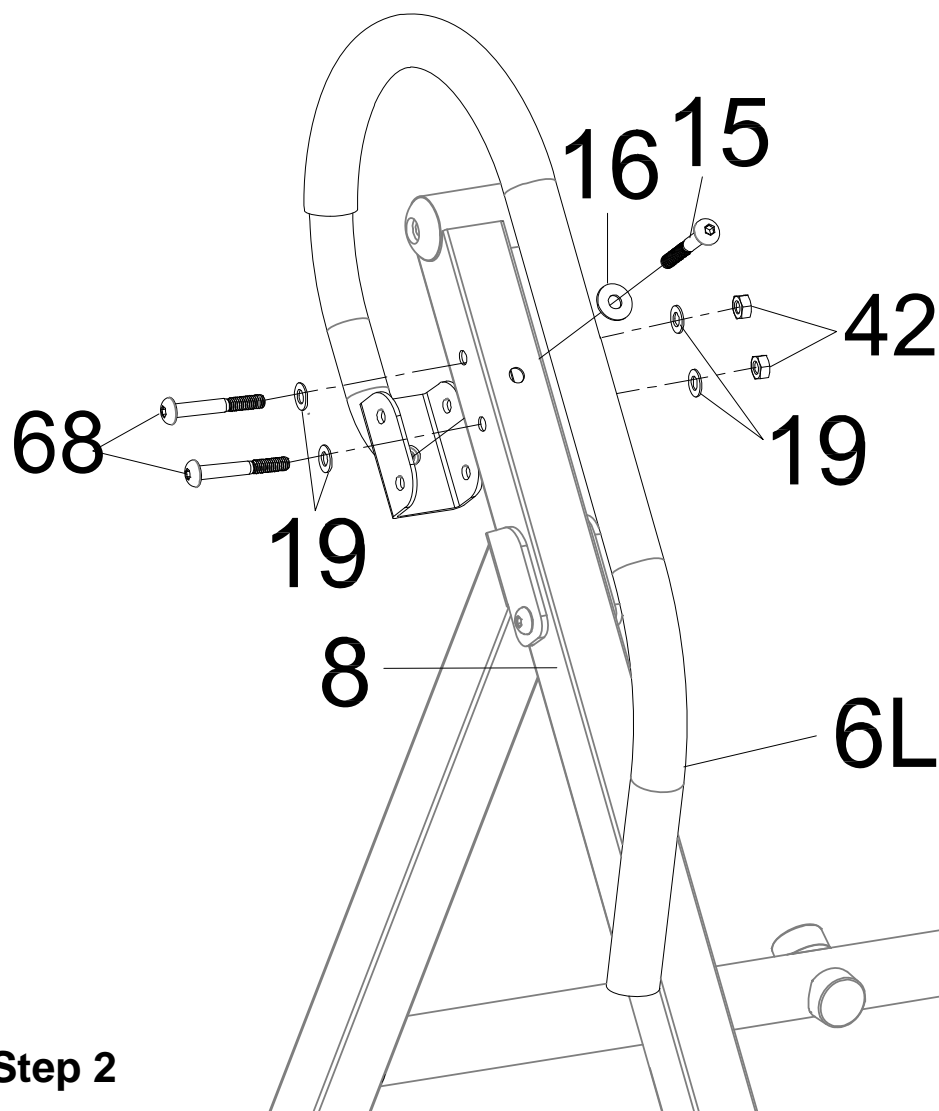

## Tools:

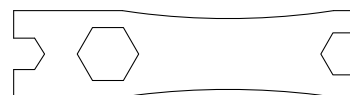

10, 13, 17mm Wrench 1PC

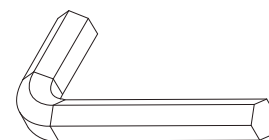

6mm Allen Wrench 1PC

## Step 2

### Installing the Left Handlebar:

**2A.** Install the **Left Handlebar (6L)** onto the **Rear Frame (8)** with two **Socket Hex Bolts (68)**, four **Flat Washers (19)**, two **Nylon Nuts (42)**, one **Socket Hex Bolt (15)** and one **Flat Washer (16)**. Tighten the hardware using the **10, 13, 17mm Wrench** and the **6mm Allen Wrench** provided.

**Note:** Install the **Socket Hex Bolt (15)** in the same orientation as displayed in the illustration above and the **Nylon Nuts (42)** should be installed on the outward facing side of the frame.

## Hardware:



(19) Flat Washer  
4PCS

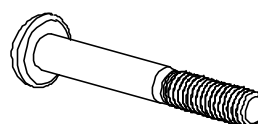

(68) Socket Hex Bolt  
2PCS

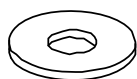

(16) Flat Washer  
1PC

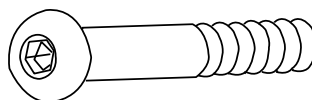

(15) Socket Hex Bolt  
1PC

# ASSEMBLY

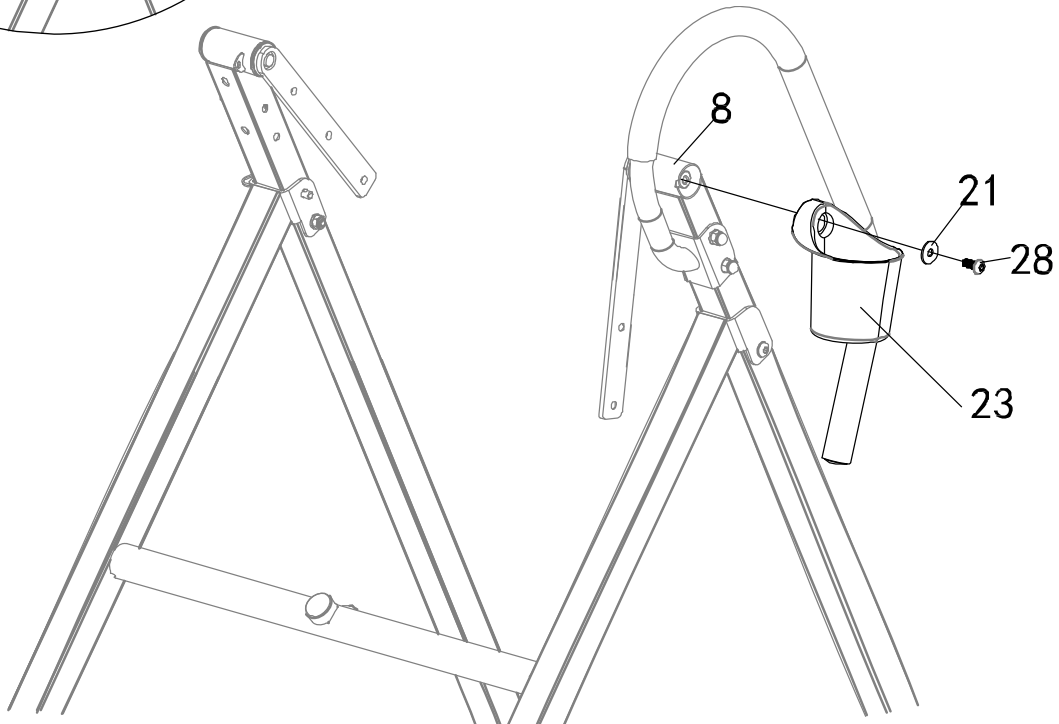
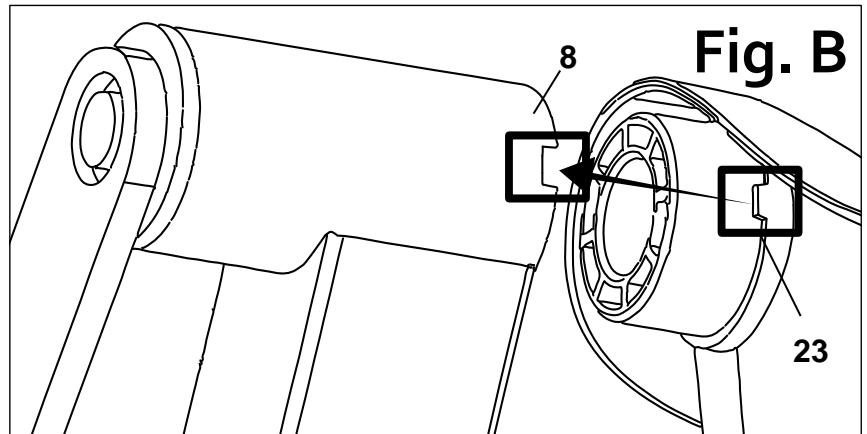
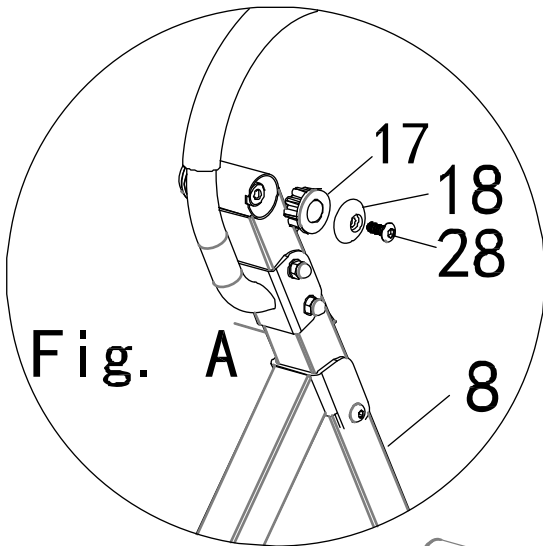

## Step 3

### Hardware Removal:

**3A.** Remove the **Plastic Spacer (17)**, **Plastic Round End Cap (18)**, and **Socket Hex Bolt (28)** from the **Rear Frame (8)** with the **6mm Allen Wrench** provided. See **Fig. A**. Keep the **Socket Hex Bolt (28)** for the **Cup Holder (23)** installation. **Discard the Plastic Round End Cap (18) and Plastic Spacer (17).**

### Installing the Cup Holder:

**3B.** Align the tabs of the **Cup Holder (23)** and the swing arm area of the **Rear Frame (8)**. See **Fig. B**. Attach the **Cup Holder (23)** onto the **Rear Frame (8)** and the **Left Pivot Arm (10L)**. with one **Flat Washer (21)** and one **Socket Hex Bolt (28)** by **6mm Allen Wrench** provided

### Hardware Pack:

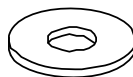

(21) Flat Washer

1 PC

# ASSEMBLY

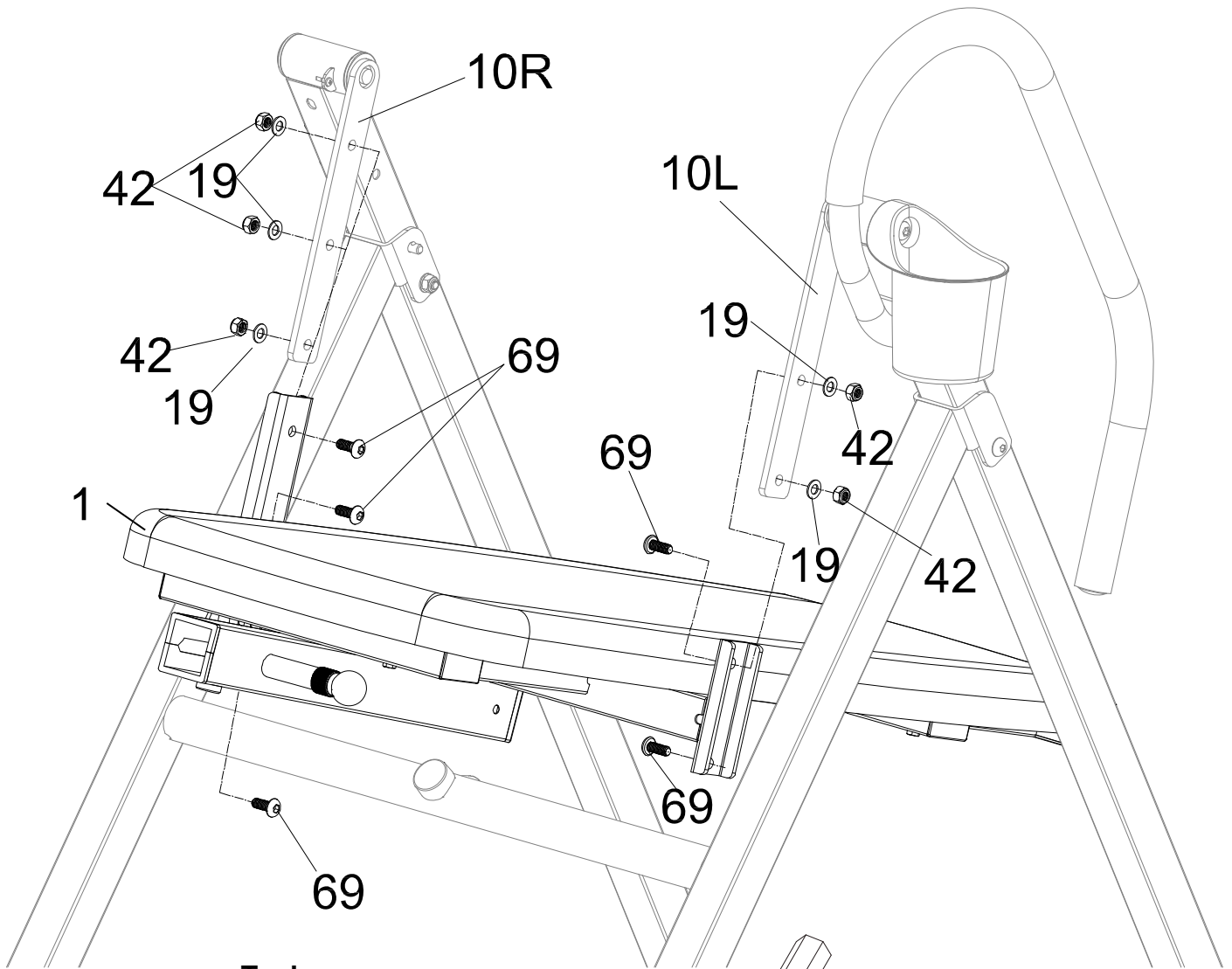

Tools:

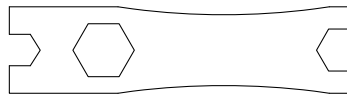

10, 13, 17mm Wrench 1PC

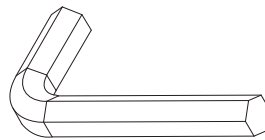

6mm Allen Wrench 1PC

## Step 4

### Installing the Backrest:

**Warning:** The **Socket Head Bolts (69)** should be installed from the inside as shown in the illustration above.

**4A.** Attach the **Backrest (1)** onto the **Left and Right Pivot Arm (10L, 10R)** by aligning the holes of the **Left and Right Pivot Arm (10L, 10R)** with the brackets of the **Backrest (1)**. Secure with five **Socket Head Bolts (69)**, five **Flat Washers (19)** and five **Nylon Nuts (42)**. Tighten the hardware with the **6mm Allen wrench** and the **10, 13, 17 mm Wrench** provided.

Hardware:

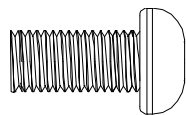

(69) Socket Hex Bolt  
5PCS



(19) Flat Washer  
5PCS

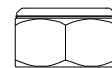

(42) Nylon Nut  
5PCS



# ASSEMBLY

## Tools:

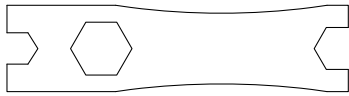

10, 13, 17mm Wrench 1PC

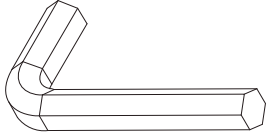

6mm Allen Wrench 1PC

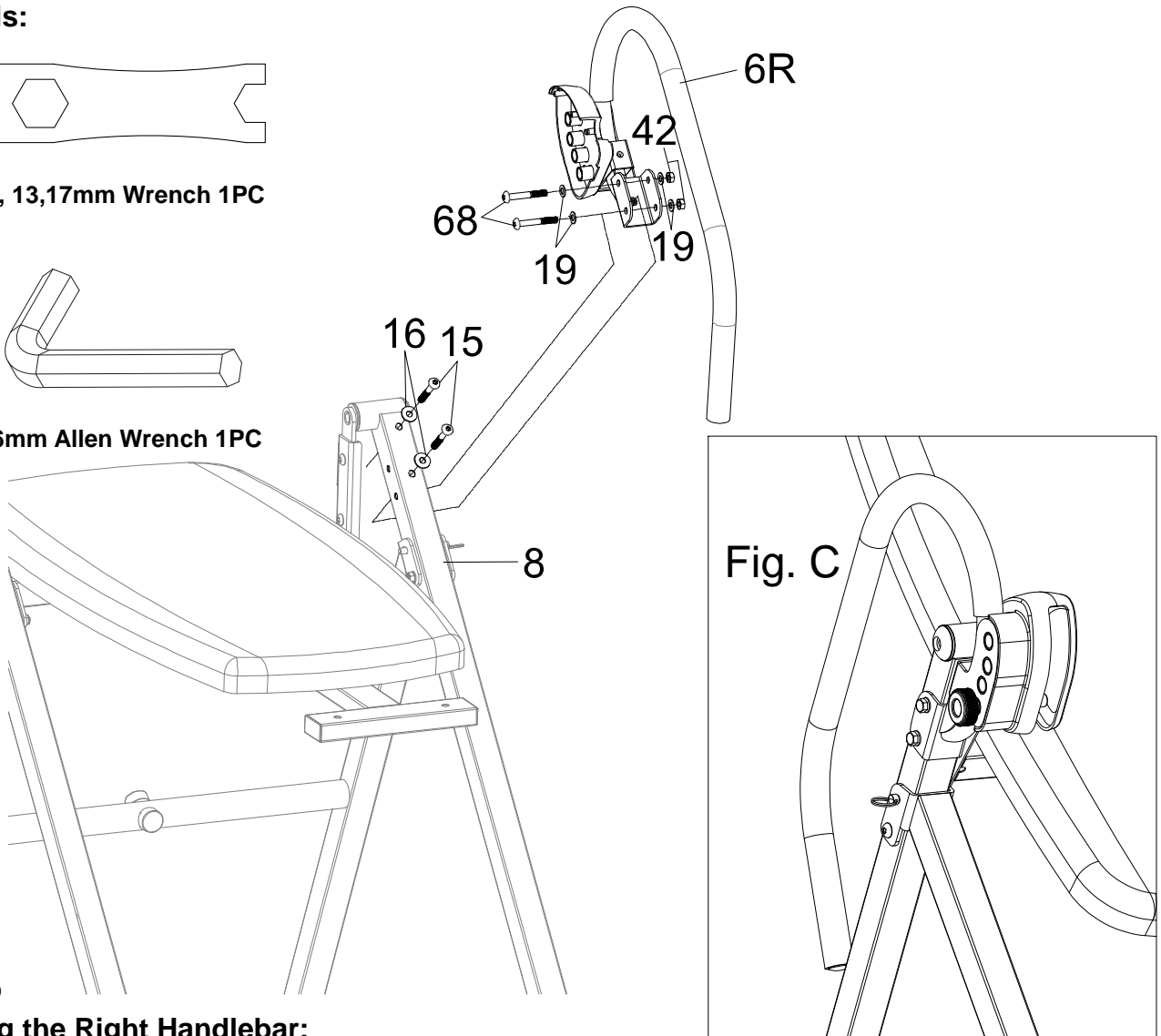

## Step 5

### Installing the Right Handlebar:

**5A.** Install the **Right Handlebar (6R)** onto the right side of the **Rear Frame (8)** with two **Socket Hex Bolts (68)**, four **Flat Washers (19)**, and two **Nylon Nuts (42)**.

**NOTE:** The **Nylon Nuts (42)** should be installed on the outward facing side of the frame.

**5B.** Install two **Flat Washers (16)** and two **Socket Head Bolts (15)** from the rear of the back side of the **Rear Frame (8)** and into the **Right Handlebar (6R)**.

**5C.** Tighten the hardware using the **6mm Allen wrench** and the **10, 13, 17 mm Wrench** provided. **See Fig D**

## Hardware:

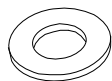

(19) Flat Washer  
4PCS

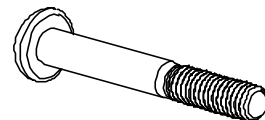

(68) Socket Hex Bolt  
2PCS

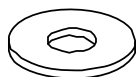

(16) Flat Washer  
2PCS

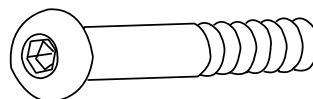

(15) Socket Hex Bolt  
2PCS

## ASSEMBLY

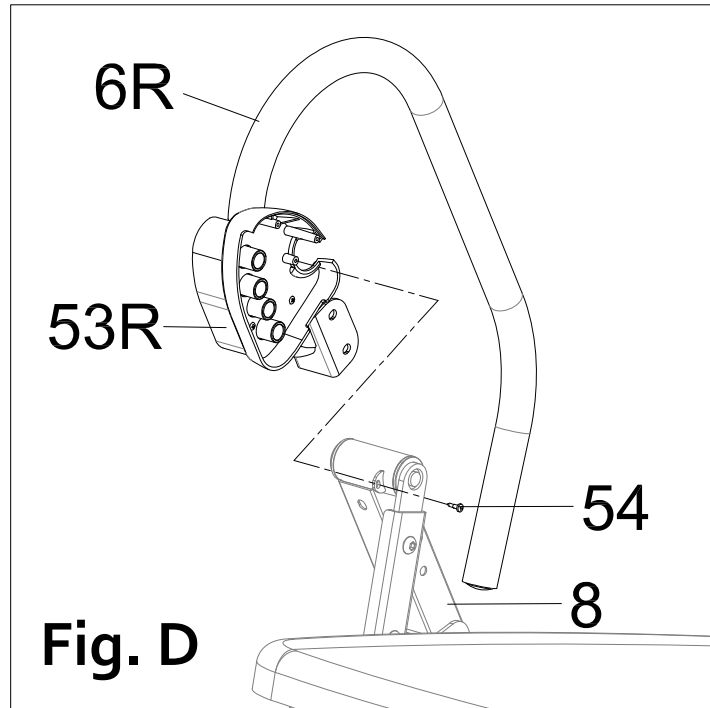

### Step 6

#### Installing the Right Handlebar Cover:

**6A.** Attach the **Right Handlebar Cover (53R)** onto the tab on the **Rear Frame (8)** with one **Self-Tapping Phillips Screw (54)**. Tighten the screw with the **Multi-Hex Tool with Phillips Screwdriver** provided. See Fig. D.

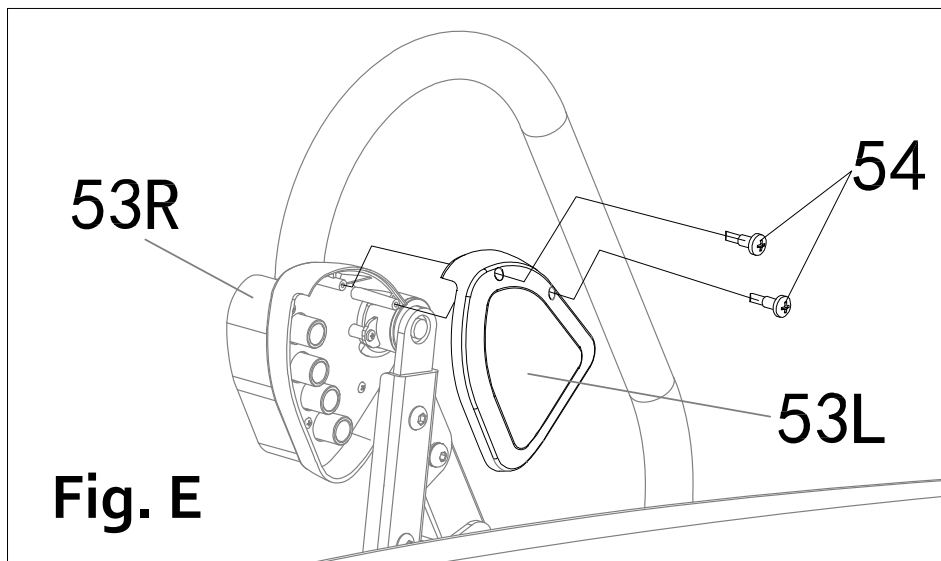

#### Installing the Left Handlebar Cover:

**6B.** Attach the **Left Handlebar Cover (53L)** to the **Right Handlebar Cover (53R)** with two **Self-Tapping Phillips Screws (54)**. Tighten the screw with the **Multi-Hex Tool with Phillips Screwdriver** provided. See Fig. E.

#### Hardware:

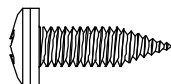

(54) Self-Tapping Phillips  
Screw 3PCS

#### Tools:

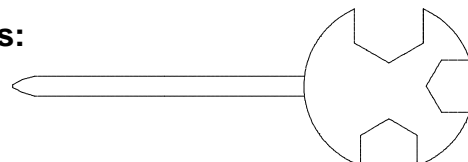

Multi-Hex Tool with Phillips  
Screwdriver 1PC

**Fig. F**

**Correct**

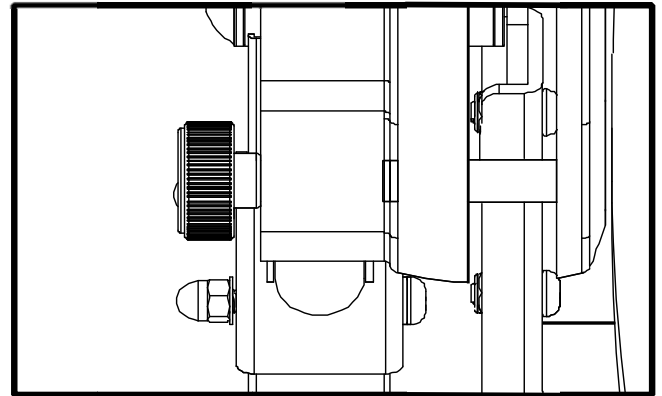

**Incorrect**

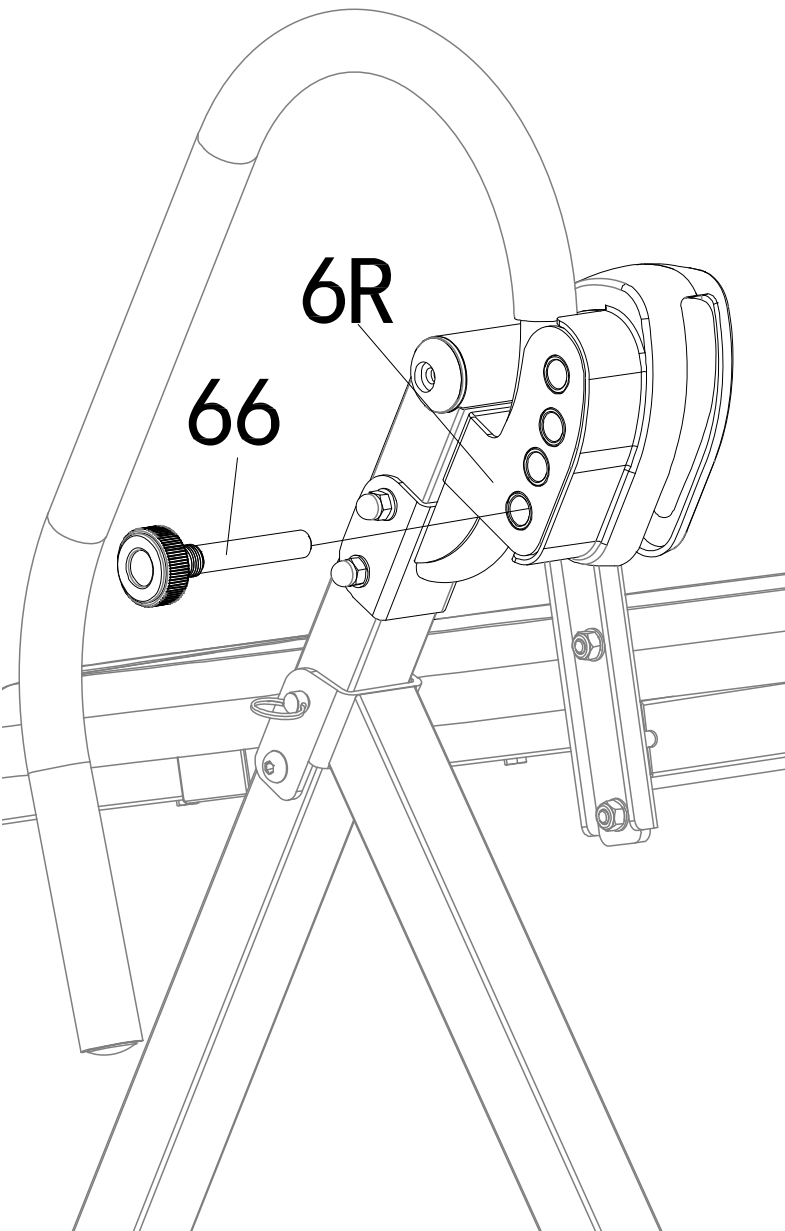
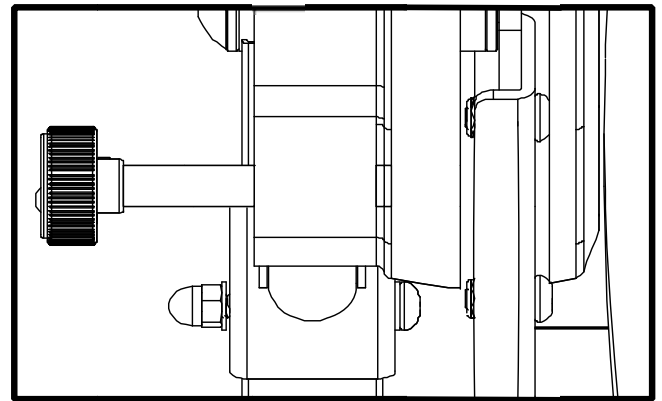

## Step 7

### Installing the Locking Pin:

**7A.** With the backrest in the upright position, insert the **Adjustable Knob (66)** into one of the holes on the **Right Handlebar (6R)**. Turn the **Adjustable Knob (66)** clockwise to tighten it.

**WARNING:** Make sure the **Adjustable Knob (66)** is fully inserted into the **Right Handlebar (6R)** before using the inversion table. The **Adjustable Knob (66)** thread should **NOT** be visible when installed correctly. **See Fig F.**

**Hardware:**

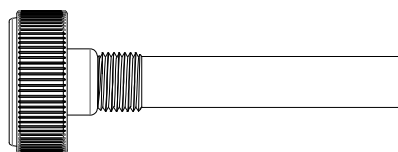

**(66) Adjustable Knob 1PC**

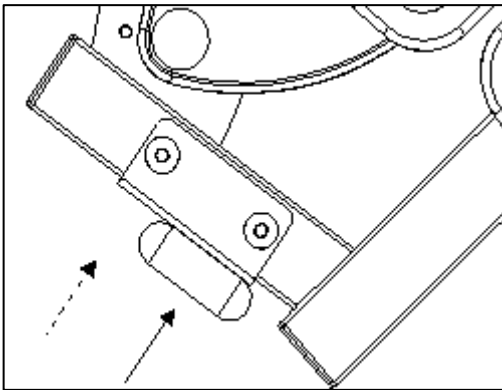

**Fig. G**

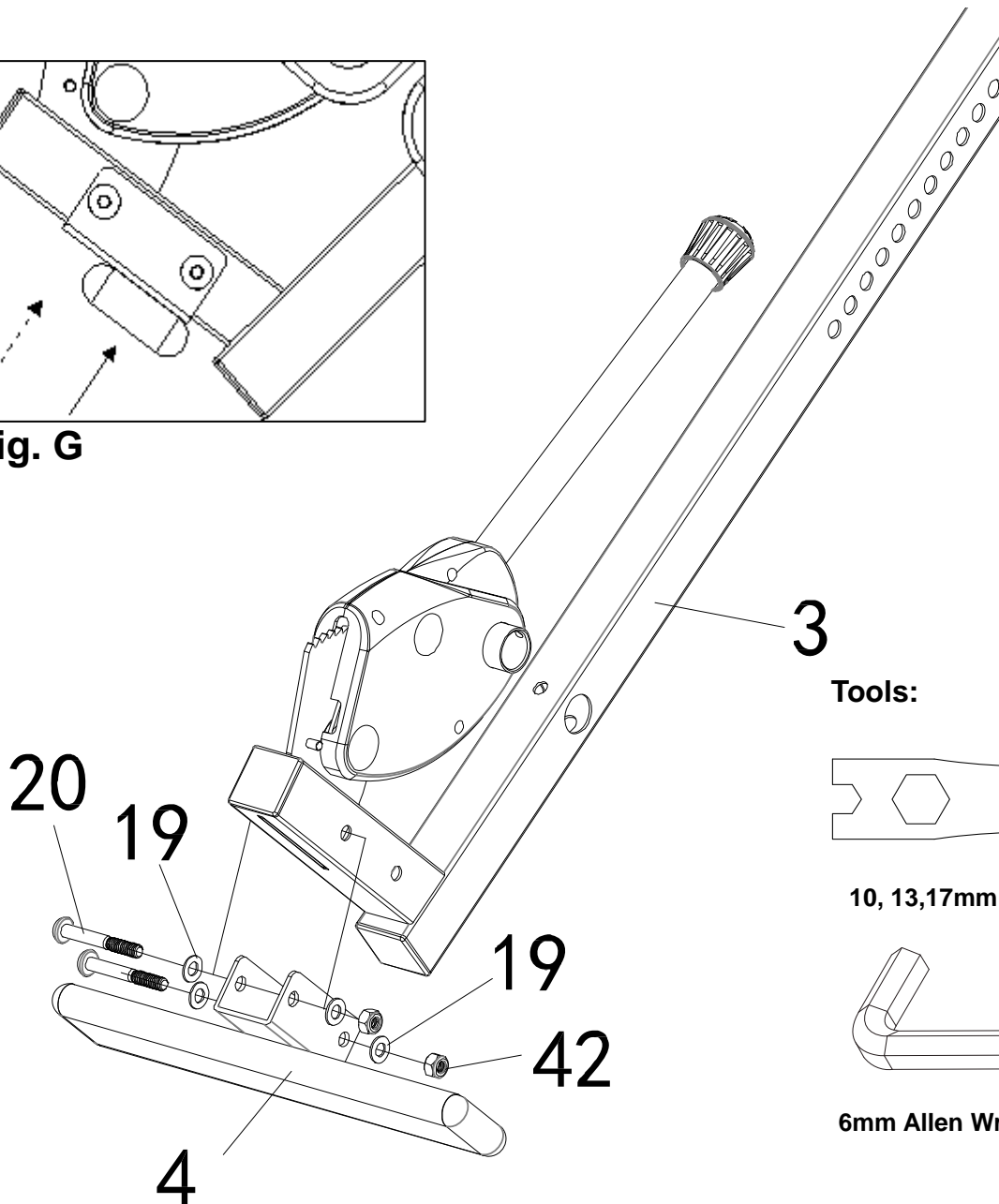

**Tools:**

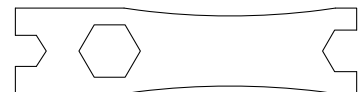

**10, 13, 17mm Wrench 1PC**

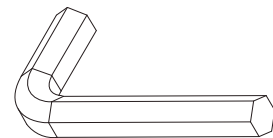

**6mm Allen Wrench 1PC**

## Step 8

### Installing the Foot Bar:

**8A.** Install the **Foot Bar (4)** onto the **Adjustable Boom (3)** with two **Socket Hex Bolts (20)**, four **Flat Washers (19)** and two **Nylon Nuts (42)**. Tighten the hardware with the **6mm Allen wrench** and **10, 13, 17 mm Wrench** provided.

**Note:** The **Foot Bar (4)** should be installed with the bar closer to the **Adjustable Boom (3)**. See **Fig. G**.

**Hardware:**

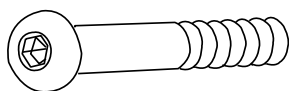

**(20) Socket Hex Bolt**  
**2PCS**



**(19) Flat Washer**  
**4PCS**



**(42) Nylon Nut**  
**2PCS**

# ASSEMBLY

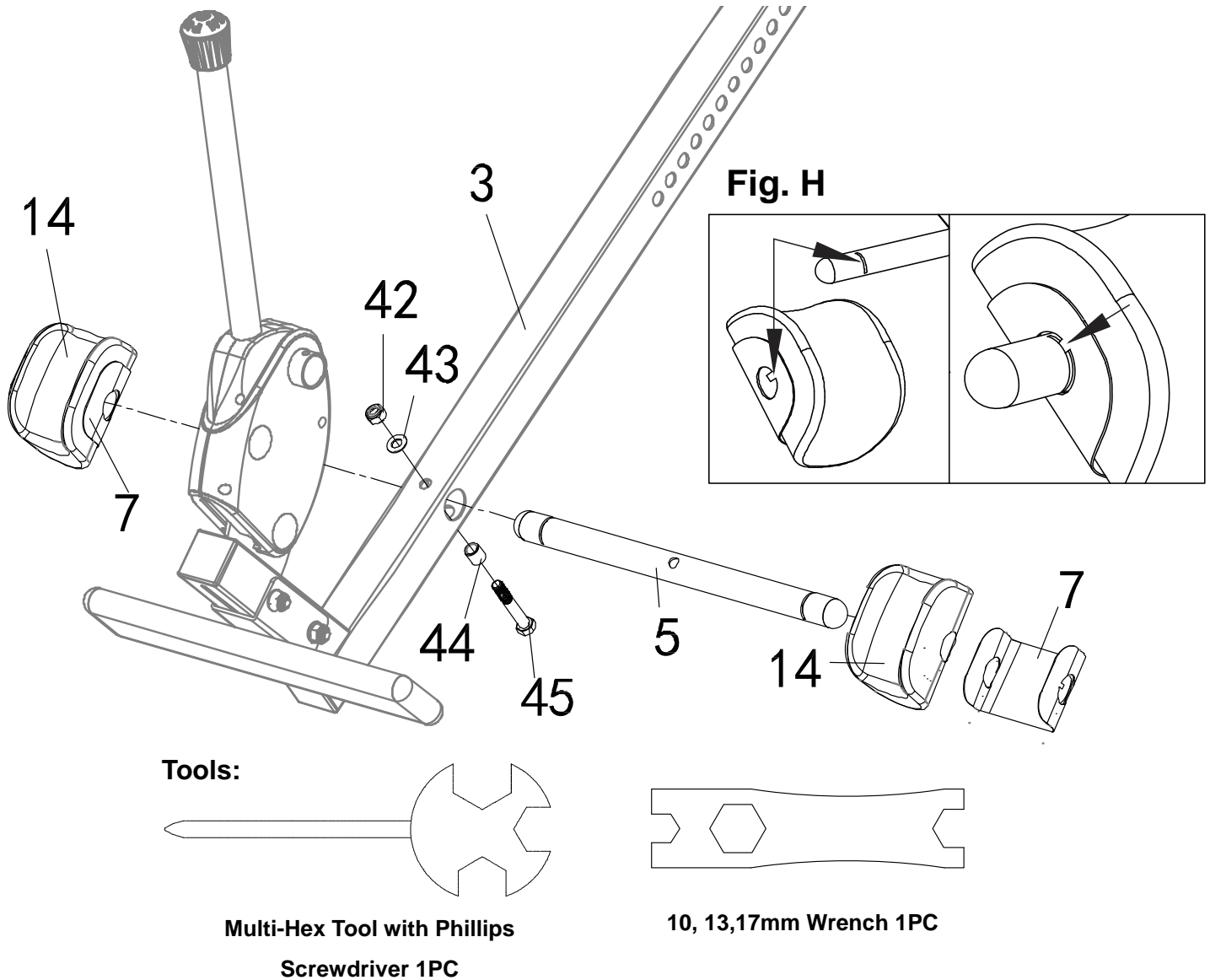

## Step 9

### Installing the Rear Rod & Heel Holders:

**9A.** Slide the **Rear Rod (5)** through the **Adjustable Boom (3)** with the slots facing forward. Secure the **Rear Rod (5)** with one **Hex Bolt (45)**, one **Metal Bushing (44)**, one **Flat Washer (43)**, and one **Nylon Nut (42)**. Tighten the hardware using the **Hex Wrench** and **Multi-Hex tool with Phillips Screwdriver** provided.

**9B.** Wrap the **Rubber Heel Holders (14)** with the **Steel Heel Holder Bracket (7)**. Squeeze the **Steel Heel Holder Brackets (7)** and **Rear Rubber Heel Holders (14)** and slide them onto both ends of the **Rear Rod (5)**. Ensure the lock teeth are wedged into the slots in the **Rear Rod (5)** as shown in the **Fig. H**.

**NOTE:** Make sure the lock teeth are wedged into the slots in the **Rear Rods (5)** before use. See **Fig. H**.

### Hardware:

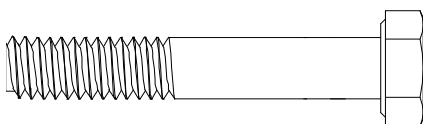

(45) Hex Bolt  
1PC



(44) Metal Bushing  
1PC



(43) Flat Washer  
1PC

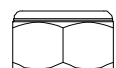

(42) Nylon Nut  
1PC

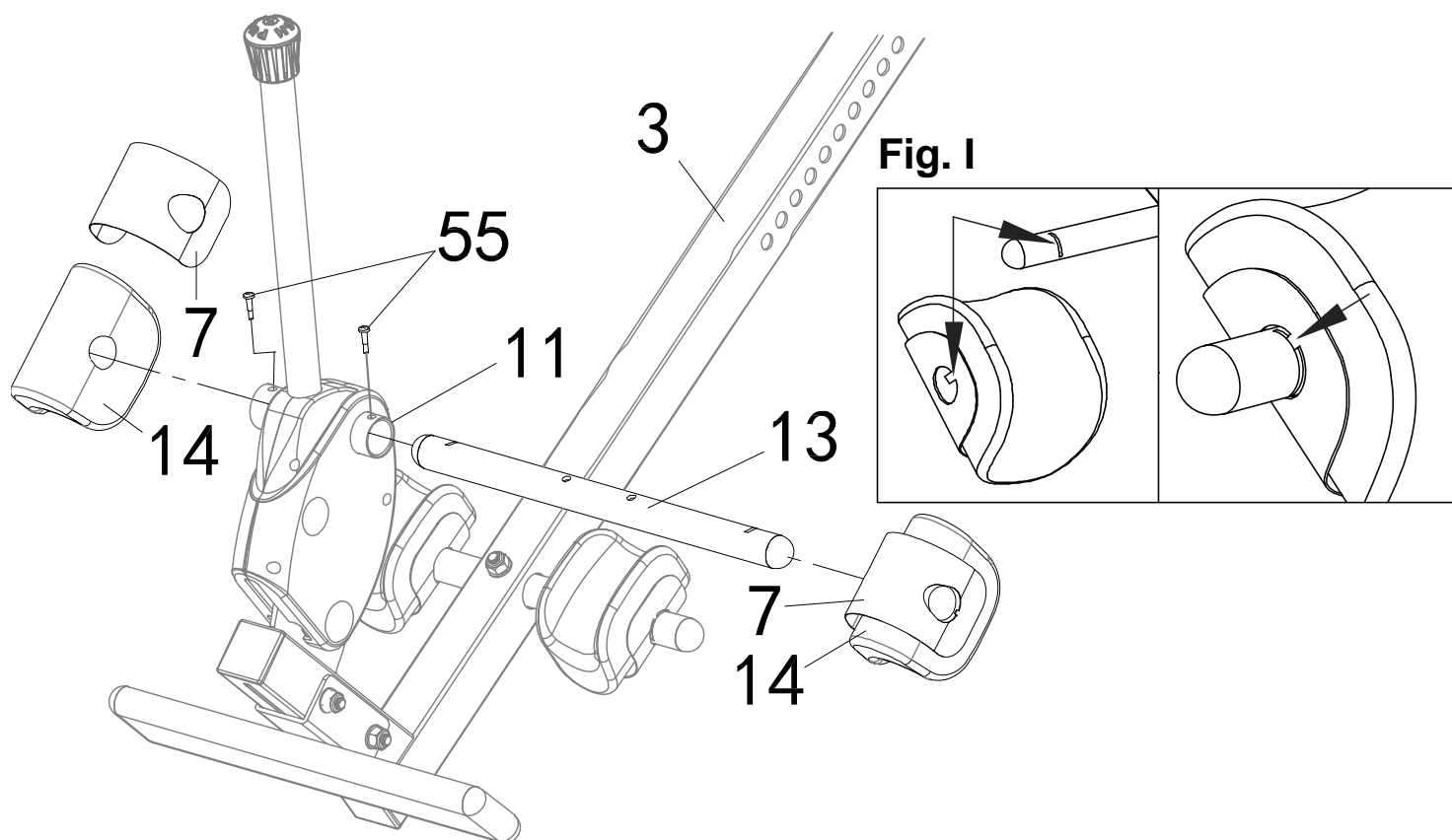

## Step 10

### Installing the Front Rod & Heel Holders:

**10B.** Slide the **Front Rod (13)** through the tube of the **Adjustable Handle (11)** with the slots facing back towards the **Adjustable Boom (3)**. Secure the **Front Rod (13)** to the **Adjustable Handle (11)** with the two **Self-Tapping Phillips Screws (55)** that were previously removed. Tighten the hardware using the **Multi-Hex tool with Phillips Screwdriver** provided.

**10C.** Wrap the **Rubber Heel Holders (14)** with the **Steel Heel Holder Bracket (7)**. Squeeze the **Steel Heel Holder Brackets (7)** and **Rear Rubber Heel Holders (14)** and slide them onto both ends of the **Front Rod (13)**. Ensure the lock teeth are wedged into the slots in the **Front Rod (13)** as shown in the **Fig. I**.

**NOTE:** Make sure the lock teeth are wedged into the slots in the **Front Rods (13)** before use. See **Fig. I**.

### Pre-Installed Hardware:



(55) Self-Tapping Phillips Screw  
2PCS

### Tools:

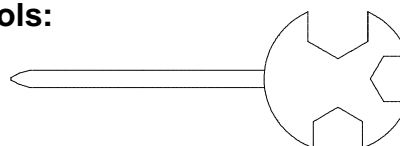

Multi-Hex Tool with Phillips  
Screwdriver 1PC

**Fig. J**

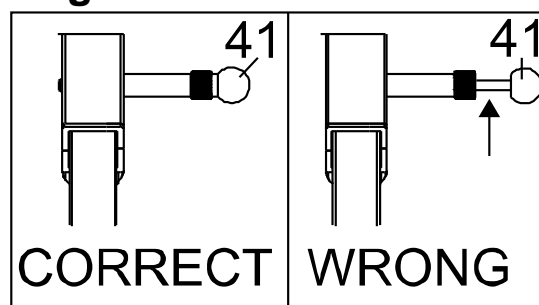

**Fig. K**

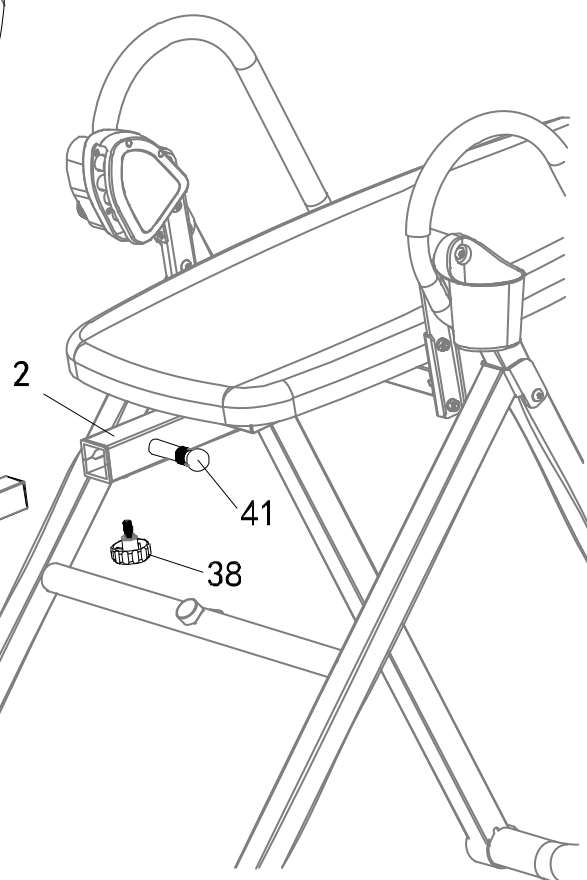
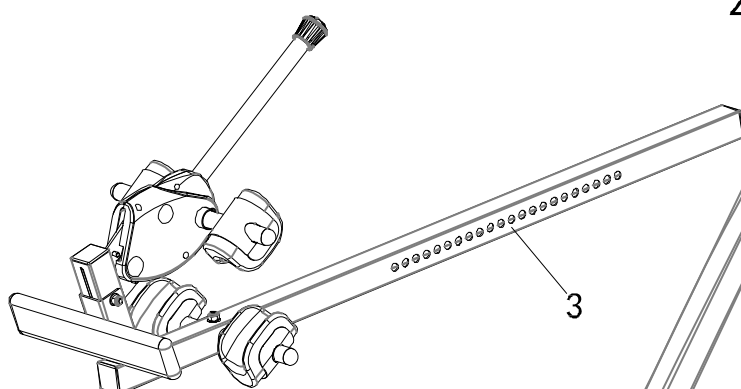
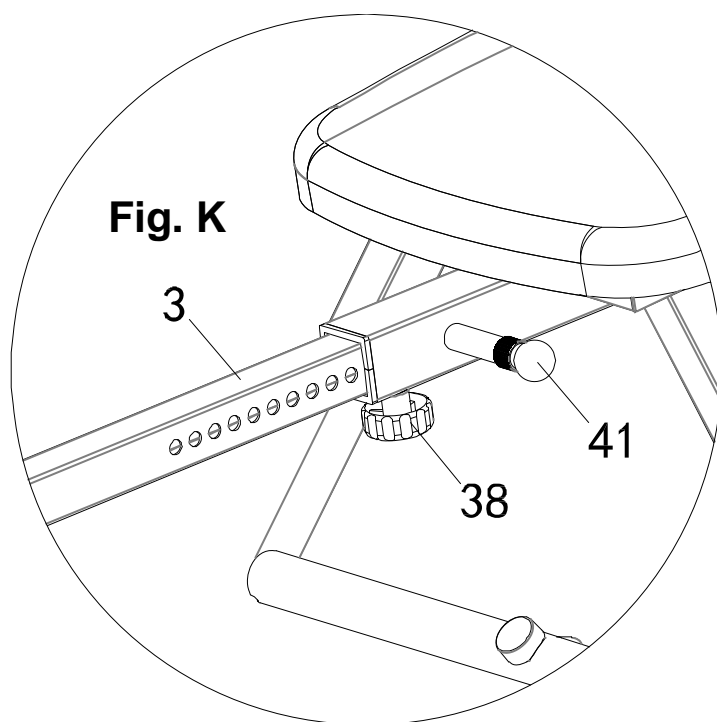

## Step 11

### Installing Adjustable Boom to the Bedframe:

**11A.** Pull out and hold the **Spring Knob (41)** then slide the **Adjustable Boom (3)** into the bottom of the **Backrest Frame (2)**. Slide the **Adjustable Boom (3)** upwards until the desired height is visible just below the tube of the **Backrest Frame (2)**. Release the **Spring Knob (41)** to lock the **Adjustable Boom (3)** in place. Shift the **Adjustable Boom (3)** until the **Spring Knob (41)** "POPS" into the locked position.

**WARNING:** Make sure the **Spring Knob (41)** is fully inserted as shown in **Fig. J** before getting on the inversion table.

**11B.** Install the **Knob (38)** onto the **Backrest Frame (2)** as shown in **Fig K**.

**WARNING:** Loosen the **Knob (38)** before adjusting the height of the **Adjustable Boom (3)**. Tighten the **Knob (38)** after adjusting the height setting of the **Adjustable Boom (3)** for stability and safety.



# ASSEMBLY

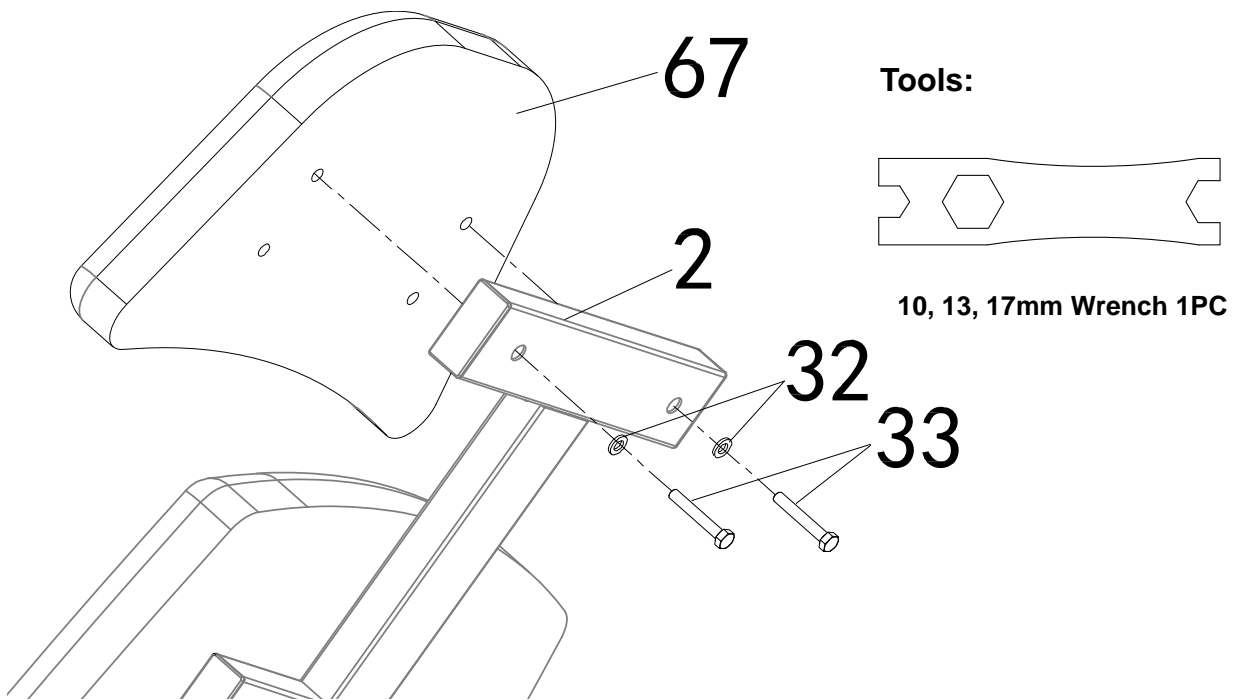

## Step 12

### Installing the Head Cushion:

**12A.** Attach the **Head Cushion (67)** on to the **Bed Frame (2)** with **two Hex Bolts (33)** and two **Flat Washers (32)**. Tighten the hardware with the **10, 13, 17mm Wrench** provided.

NOTE: There are 2 installation options for the head rest. Choose the position that fits you best.

### Installation 1 (Lower)

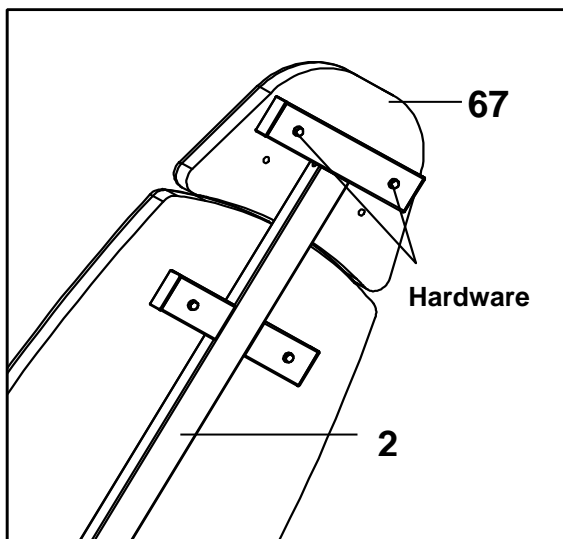

### Installation 2 (Higher)

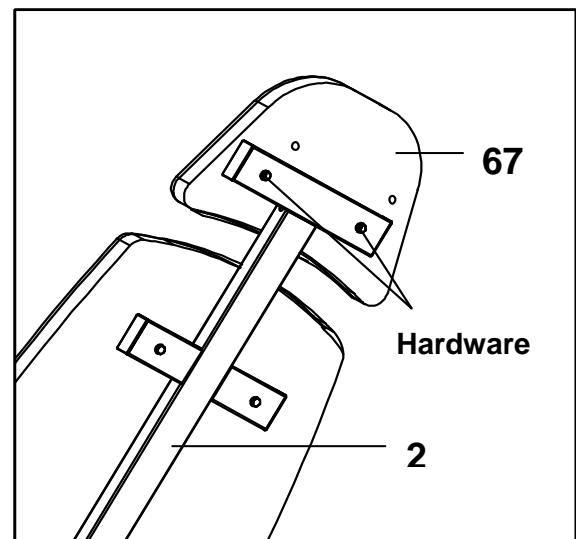

### Hardware:

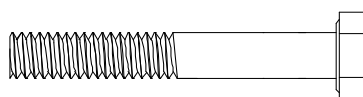

(33) Hex Bolt  
2PC

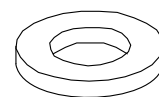

(32) Flat Washer  
2PC

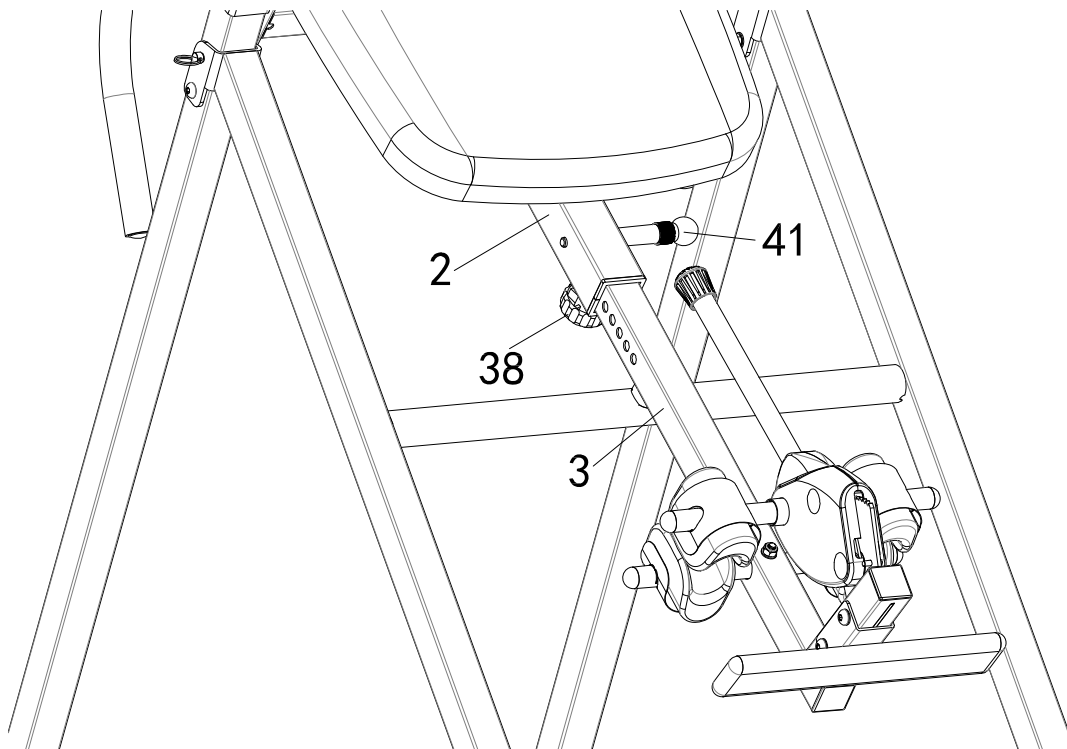

### ADJUSTING THE BOOM

The **Adjustable Boom (3)** can be moved to a variety of different positions in order to accommodate the height of the person using the inversion table.

To adjust the **Adjustable Boom (3)**:

1. Loosen the **Knob (38)** and pull out and hold the **Spring Knob (41)**.
2. Slide the **Adjustable Boom (3)** up or down until the desired height is just visible below the tube connected to the **Backrest Frame (2)**.
3. When the **Adjustable Boom (3)** is in the desired position, release the **Spring Knob (41)** and slide the **Adjustable Boom (3)** slightly up or down until the **Spring Knob (41)** locks into place with a “POP” sound.
4. Tighten the **Knob (38)** to secure the **Adjustable Boom (3)** before use.

**WARNING:** Make sure the **Spring Knob (41)** is inserted all the way through the **Backrest Frame (2)** before getting onto the inversion table.

**WARNING:** The **Knob (38)** must be tightened every time the user height setting is changed for additional stability and safety.

## GENERAL PRECAUTIONS

1. It is recommended that someone be with you while you are using this inversion table for the first few times.
2. Always wear shoes when using the inversion table.
3. Make sure that the **Rubber Heel Holders (14)** are secure around your ankles before inverting.
4. Make sure that the **Adjustable Boom (3)** is properly set to your height.
5. Make sure that the **Adjustable Boom (3)** is held securely by the **Spring Knob (41)**.
6. Make sure that there is enough room for the inversion table to rotate completely.

## THE HANDLEBARS

For added convenience and safety, a set of **Handlebars (6)** has been added to the inversion table. These **Handlebars (6)** are located at the top of the **Rear Frame (8)**. The **Handlebars (6)** are there to help you return to the upright position from any degree of inversion. If you wish to return to the upright position, and the backrest is moving too slowly, or not moving at all, slowly pull on the handlebars until you return to the upright position.

**NOTE:** The inversion table should always return to the upright position when you move your hand's closer to your starting position along the handlebars. If it does not, get off the inversion table and adjust the height setting before your next use. Go back slowly; failure to comply could result in serious physical injury.

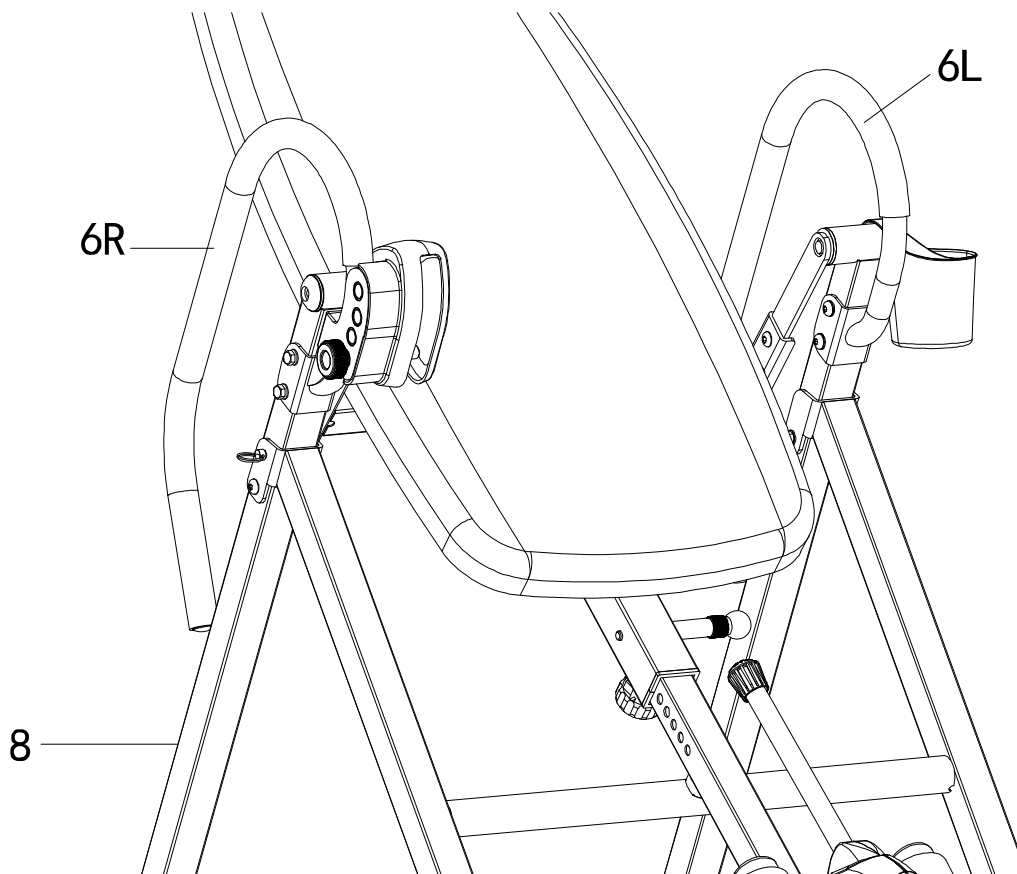

## INVERSE PIN CONTROL

To control the angle of inversion insert the **Adjustable Knob (66)** into one of the holes shown below.

**Inversion Degrees**  
**20°**

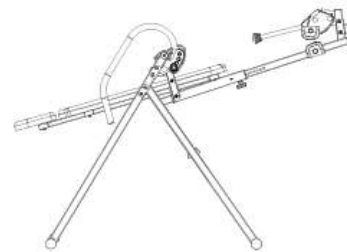
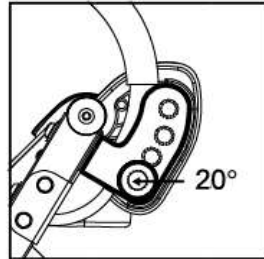

**35°**

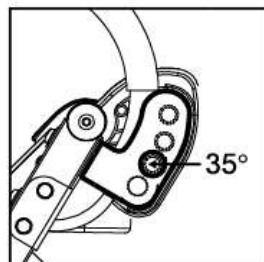

**55°**

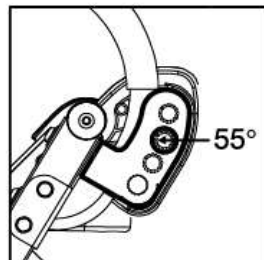

**75°**

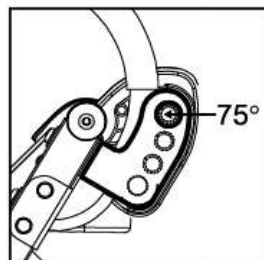

**Full Inversion**

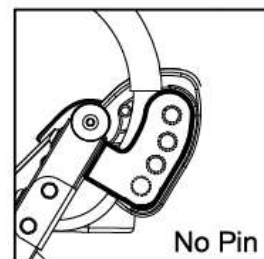

## OPERATION & ADJUSTMENTS

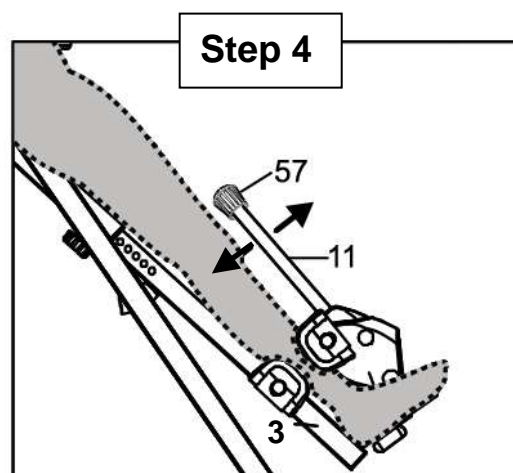
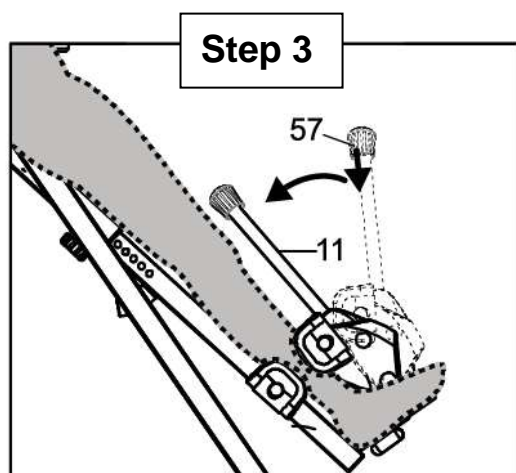
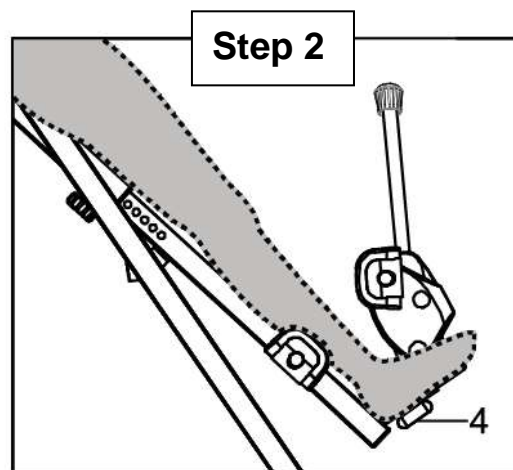
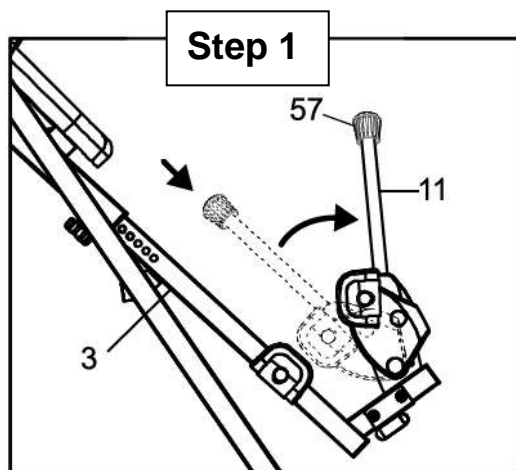

### ADJUSTING THE FRONT AND REAR RUBBER HEEL HOLDERS

1. Push down on the **Button (57)** and move the **Adjustable Handle (11)** away from the **Adjustable Boom (3)**.
2. Step onto the **Foot Bar (4)** and place your ankles between the Front/Rear **Rubber Heel Holders (14)**.
3. Push down on the **Button (57)** and move the **Adjustable Handle (11)** back towards the **Adjustable Boom (3)** until the **Rubber Heel Holders (14)** are snug around your ankles.
4. Move the **Adjustable Handle (11)** back and forth without pressing the **Button (57)** to ensure that the ratchet is locked.

**WARNING:** Ensure that the Rubber Heel Holders (14) are securely holding onto your ankles.

**WARNING:** Make sure the Adjustable Handle (11) is locked in place after the Rubber Heel Holders (11) are secure around your ankle.

### BALANCING THE INVERSION TABLE

The inversion table is like a very sensitively balanced fulcrum. It responds to very slight changes in weight distribution. So it is very important to make sure that the height is adjusted properly. To do this, mount the inversion table, lock your ankles into the heel holders, and lie back straight with your hands on the handlebars. Slowly allow yourself to tilt back with your hands lightly gripping the handles bars right above your waist. While in this position, your head should still be slightly above your feet. If your feet are above your head, increase the boom height by an inch (Example: Increase the boom height from 5'6" to 5'7"), and repeat the balancing steps above. Increase the boom height until your head is slightly above your feet.

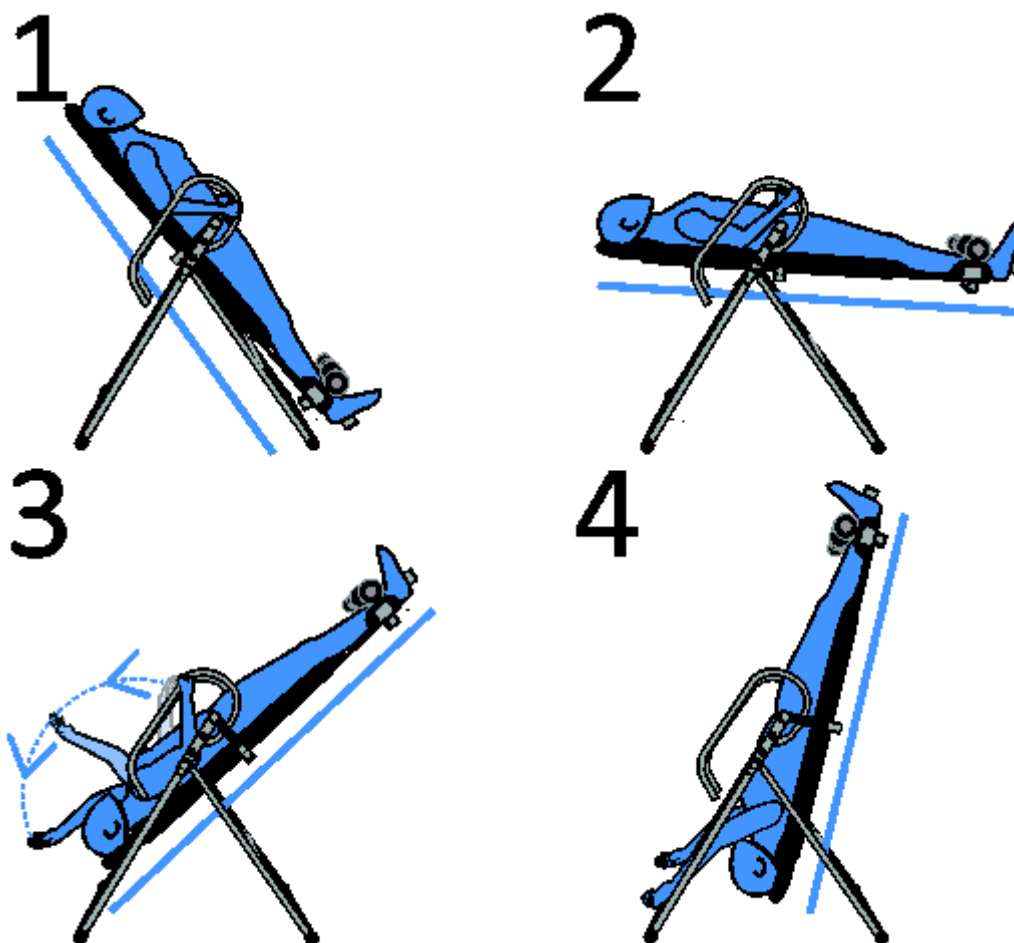

### USING THE INVERSION TABLE

1. Start by lying straight back on the backrest with your hands gripped on both handlebars.
2. Relax your grip slightly on the handlebars, and allow yourself to slowly tilt back. Your head should be slightly above your feet when in this position until you are ready to start inverting, as described in the BALANCING THE INVERSION TABLE section above.
3. **To start inversion**, slowly lift one hand over your head while still gripping a handlebar with the opposite hand.
4. **To increase the degree of inversion further**, slowly lift your other arm off the handlebars and rotate it above your head so that both arms are hanging freely.
5. Return to the upright position by slowly returning your hands to your waist and pulling yourself up with the handlebars.

### SUGGESTIONS FOR USE

1. Begin slowly: invert only 15~20 degrees to begin with. Stay inverted only as long as you are comfortable. Return upright slowly if you feel uncomfortable.
2. Make gradual changes: increase the angle only if it is comfortable. Increase the angles only a few degrees at a time. You may want to increase your routine from 1-2 minutes to 5 minutes over time. Do so only if you feel comfortable, so listen to your body. Invert however long you are comfortable.
3. Throughout the inversion, remember to always check up on how you are feeling. If you begin to feel nauseous during use come up as soon as you can. Come up slowly, dizziness after a session means you came up too fast. Wait 2 hours after eating to use the inversion table.
4. All inversion benefits can be gained without having to invert completely; small degrees of inversion will provide the same benefits. Do not push yourself to greater degrees of inversion if you are not comfortable.
5. Invert regularly: We recommend two or three times a day depending upon your current condition; talk to your personal care physician. We recommend inverting around the same time daily to gain the most benefits from inversion.
6. **These are general recommendations; consult your personal care physician before using this product.**



## STORAGE

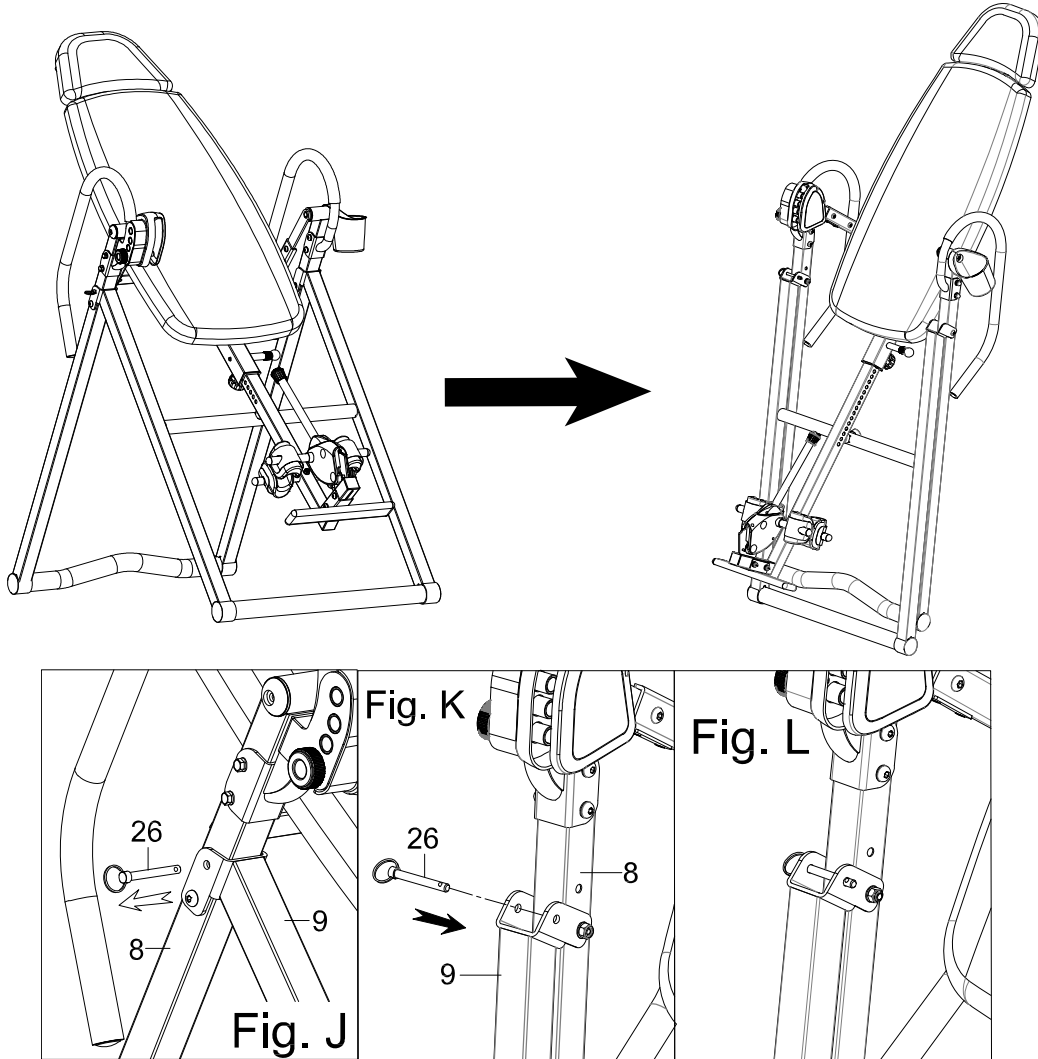

## FOLDING THE INVERSION TABLE

For your storage convenience, the inversion table can be folded down to place against a wall, under a bed, or in a storage area.

1. Pull out the **Safety Pin (26)** from the holes on the **Rear Frame (8)** and **Front Frame (9)**.

**Fig. J**

2. Push the **Rear Frame (8)** and **Front Frames (9)** together all the way. **Fig. K**

3. Insert the **Safety Pin (26)** back into the hole on the **Front Frame (9)**. **Fig. L**

Reverse the steps to set up the inversion table when you want to use it.

## MAINTENANCE INSTRUCTIONS

You should check your inversion table for any kind of wear and tear before each use.

1. Check the pivot arms, backrest, and heel holders for wear and tear.
2. Replace any damaged and worn components immediately.
3. Keep all damaged equipment out of use until it is repaired or replaced.
4. Tighten all loose hardware, bolts, nuts, and caps before using the inversion table.

# WARRANTY

## **MANUFACTURER'S LIMITED WARRANTY**

Paradigm Health & Wellness warrants to the original purchaser that this product is free from defects in material and workmanship when used for the purpose intended, under the conditions that it has been installed and operated in accordance with Paradigm's Owner's Manual. Paradigm's obligation under this warranty applies to the following:

## **COMPONENT LENGTH OF WARRANTY**

|                      |                           |
|----------------------|---------------------------|
| Structural Frame     | 1 year For Home Use Only  |
| All Other Components | 90 days For Home Use Only |

## **Exclusions from Warranty Coverage:**

Paradigm does not warrant against and is not responsible for, and no implied warranty shall be deemed to cover, any product failure, product malfunction, or damages attributable to:

1. Improper installation and/or failure to abide by Paradigm's installation guidelines;
2. Use of this product beyond normal home use, or in an application for which it was not designed;
3. Cosmetic items such as scratches, dents or discolorations;
4. Damage caused by normal wear and tear, vandalism, accidental or by animals;
5. Any act of Nature (such as fire, flooding, snow, ice, hurricane, earthquake, lightning or other natural disaster), environmental condition (such as air pollution, mold, mildew, etc.), or staining from foreign substances (such as dirt, grease, oil, etc.);
6. Normal weathering due to exposure to sunlight, weather, and atmosphere which can cause colored surfaces to, among other things, flake, chalk, accumulate dirt or stains.
7. Improper operation, alteration, handling, storage, abuse or neglect of the products.

**Paradigm, using its sole discretion, will either repair or replace free of charge any part(s) proven to be defective under normal home use. Any repair or replacement shall provide no new warranty coverage, but shall retain only the remaining portion of the original product's warranty. This warranty is offered only to the original purchaser and is not transferable. Proof of original purchase is required.**

## **Ordering Replacement Parts**

Replacement parts can be ordered by calling or emailing our customer service department:  
Open Monday thru Friday, 8:00 AM - 5:00 PM (PST).

**service@paradigmhw.com**

When ordering replacement parts have the following information ready:

1. Owner's Manual
2. Model Number
3. Description of Parts
4. Part Number
5. Date of Purchase

## PARTS REQUEST FORM

### Paradigm Health & Wellness, Inc.

EMAIL THIS FORM WITH YOUR RECEIPT OF PURCHASE TO

**Service@paradigmhw.com** \*

NAME: \_\_\_\_\_

ADDRESS: \_\_\_\_\_

CITY: \_\_\_\_\_ STATE: \_\_\_\_\_ ZIP: \_\_\_\_\_

TELEPHONE: (Day) \_\_\_\_\_

(Night) \_\_\_\_\_

SERIAL#: \_\_\_\_\_

MODEL#: \_\_\_\_\_

PURCHASE DATE: \_\_\_\_\_

PLACE OF PURCHASE: \_\_\_\_\_

| PART # | DESCRIPTION | QTY |
|--------|-------------|-----|
|        |             |     |
|        |             |     |
|        |             |     |
|        |             |     |
|        |             |     |
|        |             |     |
|        |             |     |
|        |             |     |
|        |             |     |
|        |             |     |

**“YOUR ORDER WILL BE PROCESSED WITHIN 3 BUSINESS DAYS”**

This form can also be faxed to #: 626-810-2166