

Portable infrared Heater

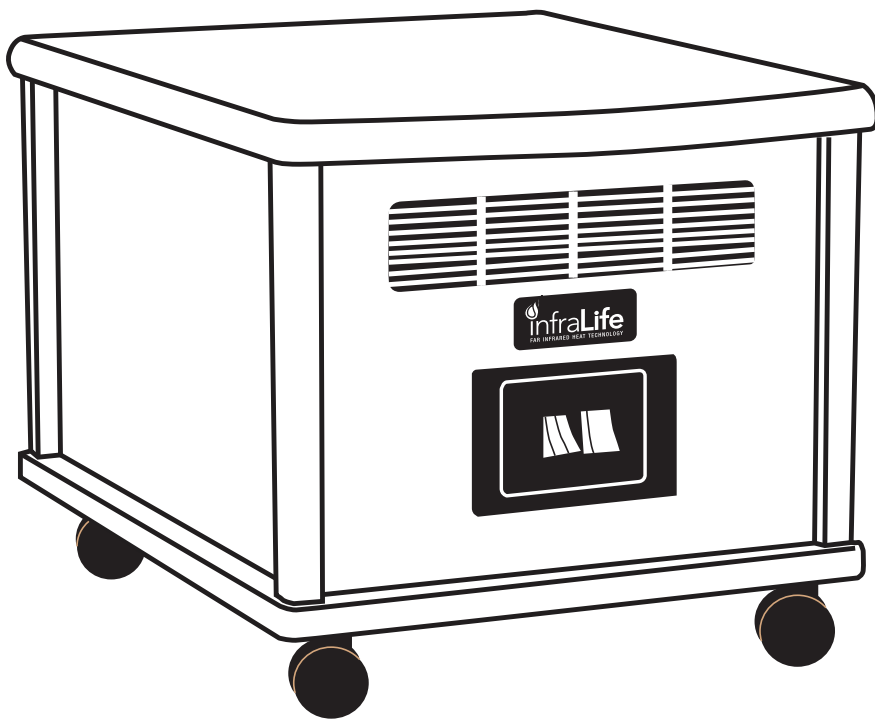

Item #9710

OWNER'S MANUAL

TABLE OF CONTENTS

SERVICE -----	2
IMPORTANT LABELS -----	3
SAFETY PRECAUTIONS -----	4
PART DRAWING -----	5
PART LIST -----	6
OPERATING INSTRUCTIONS -----	7
MAINTENANCE -----	8
WARRANTY -----	9
FAX FORM -----	10

SERVICE

IMPORTANT: FOR NORTH AMERICA ONLY

**To request product service and order replacement parts, please call our customer service department at:
1-866-924-1688**

Monday through Friday, 8:00 AM-5:00 PM Pacific Standard Time,

or email us at: service@paradigmhw.com

Please visit our website at www.paradigmhw.com.

Please have the following information ready when requesting for service:

Your name

Phone number

Model number

Serial number

Part number

Proof of Purchase

***Before returning this product to the store please contact customer service at the contact number.**

Paradigm Health & Wellness, Inc.

1189 Jellick Ave, City of Industry, CA 91748, USA

IMPORTANT LABELS

WARNING
WARNING: RISK OF FIRE-KEEP COMBUSTIBLE MATERIAL AWAY FROM FRONT OF HEATER.
AVERTISSEMENT: RISQUE D'INCENDIE-NE LAISSEZ PAS DE MATERIAU COMBUSTIBLE DEVANT LE RADIATEUR.

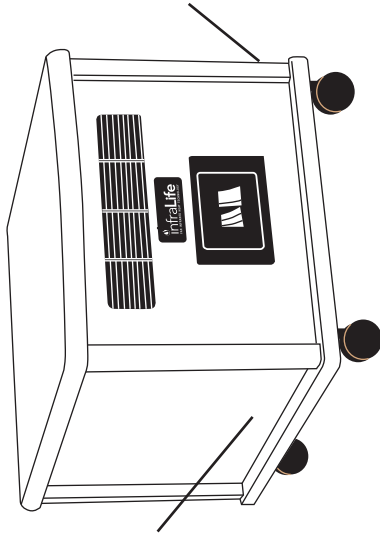

WARNING
Risk of Fire-Keep combustible material such as furniture, papers, clothes, and curtains at least 3 feet (0.9M) from the front of the heater and away from the sides and rear.
Avvertissement
Gardez les matériels aux risqué de combustibles tel que des meubles, des papiers de vêtements, des rideaux au moins 3 pieds, (0.9M) de l'avant du réchauffeur et loin du côté et de l'arrière.

This WARNING label is stuck on the power cord.

WARNING- TO REDUCE THE RISK OF FIRE:

1. Always plug heaters directly into a wall outlet (no extension cord or relocatable power tap (outlet/power strip)).
2. Check your heater cord and plug connections. A loose fitting outlet can cause the plug to overheat and /or cause a fire. Be sure plug fits snugly in the outlet. Check frequently during use to make sure plug and outlet are not overheating. Do not use the heater if the plug or outlet is damaged or if the heater is not working properly.
3. Always unplug heater when not in use.
4. Do not operate heater with a damaged cord or plug or after the heater has been damaged in any way. If the heater is damaged, do not use it. Return to an authorized service facility for examination and /or repair.
5. Do not run cord under carpeting. Do not cover cord with throw rugs, runners, or similar coverings. Do not route cord under furniture or appliances. Keep cord away from high traffic areas so it will not be tripped over.

DO NOT REMOVE THIS TAG!

AVERTISSEMENT -POUR REDUIRE LER RISQUES D'INVENDE

1. Appuyez de chauffage doit toujours être branché directement dans une prise murale (sans câble d'extension ou prise de courant déplaçable).
2. Vérifiez votre cordon chauffant et les connexions. Une connexion lâche peut provoquer la prise en feu ou l'incendie. Vérifiez fréquemment pendant l'utilisation pour déterminer si votre prise de prise ou le cordon ou la prise de courant sont endommagés. Ne pas utiliser le chauffage si la prise ou le cordon ou la prise de courant sont endommagés.
3. Toujours brancher le radiateur lorsqu'il n'est pas utilisé.
4. Ne pas fonctionner le radiateur avec un cordon ou une fiche endommagée ou après avoir été endommagé de quelque manière que ce soit. Si le radiateur est endommagé, ne pas l'utiliser. Retourner à un centre de service autorisé pour examen et /ou réparation.
5. Ne pas passer le cordon sous un tapis. Ne pas couvrir le cordon avec des tapis, ni de tout autre. Ne pas passer sous des meubles ou des appareils. Placez le cordon des autres des circulation et /ou il ne sera pas trippé.

NE PAS RETIRER LE PRESENT TAG



CAUTION
RISK OF ELECTRIC SHOCK
NO USER-SERVICEABLE PARTS INSIDE
ATTENTION
Risque de choc électrique
Sans pièce utilisable sans utilisation à l'intérieur

Paradigm Health & Wellness Inc.
Model: 9710
Rated voltage: 120V
Rated Frequency: 60Hz
Input Power: Max. 1500W (25°C)
1650W (0°C)
Made in China
Series NO.:
311090
CONFORMS TO
ULSTD. NO.1278
CERTIFIED TO
CSA STD. C22.2 NO.46

SAFETY PRECAUTIONS

When using this heater, basic safety precautions should always be followed to reduce the risk of fire, electric shock, and injury to persons, including the following:

1. Read all manual before using this heater.
2. **WARNING:** Risk of Fire-Keep combustible material away from front of heater.
3. **WARNING:** Risk of Fire-Keep combustible material such as furniture, papers, clothes, and curtains at least 3 feet (0.9M) from the front of the heater and away from the sides and rear.
4. Always plug heater directly into a wall outlet/receptacle. Never use with an extension cord or relocatable power tap (outlet/power strip).
5. Check your heater cord and plug connections. A loose fitting outlet can cause the plug to overheat and/or cause a fire. Be sure plug fits snugly in the outlet. Check frequently during use to make sure plug and outlet are not hot. If so, discontinue using heater and have outlet replaced by a qualified electrician.
Note: Heater draw more current than small appliances, overheating of the outlet may occur even if it has not occurred with the other appliances.
6. Always unplug the heater when not in use.
7. Do not operate heater with a damaged cord or plug or after the heater malfunctions, has been dropped or damaged in any manner. Discard heater or return to an authorized service facility for examination and/or repair.
8. Do not run cord under carpeting. Do not cover cord with throw rugs, runners, or similar coverings. Do not route cord under furniture or appliances. Keep cord away from high traffic areas so it will not be tripped over.
9. Do not try to open or repair the heater yourself.
10. The surfaces of the heater may get hot when in use. To avoid burns, do not touch the hot surfaces.
11. Close supervision is necessary when this unit is used by or near children, invalids or disabled persons.
12. Do not use outdoors.
13. For Household Use Only.
14. Do not touch the control panel or plug with a wet hand.
15. Keep heater away from heated surfaces.
16. Plug must be plugged into an appropriate socket or outlet that is properly installed. Improper connection can result in the risk of electric hazard.
17. To disconnect, turn all controls to the off position, then remove plug from outlet.
18. Always unplug the heater before moving or cleaning.
19. Always use the unit on a dry and level surface.

CAUTION: Read all instructions carefully before operating this product. Retain this Owner's Manual for future reference.

PART DRAWING

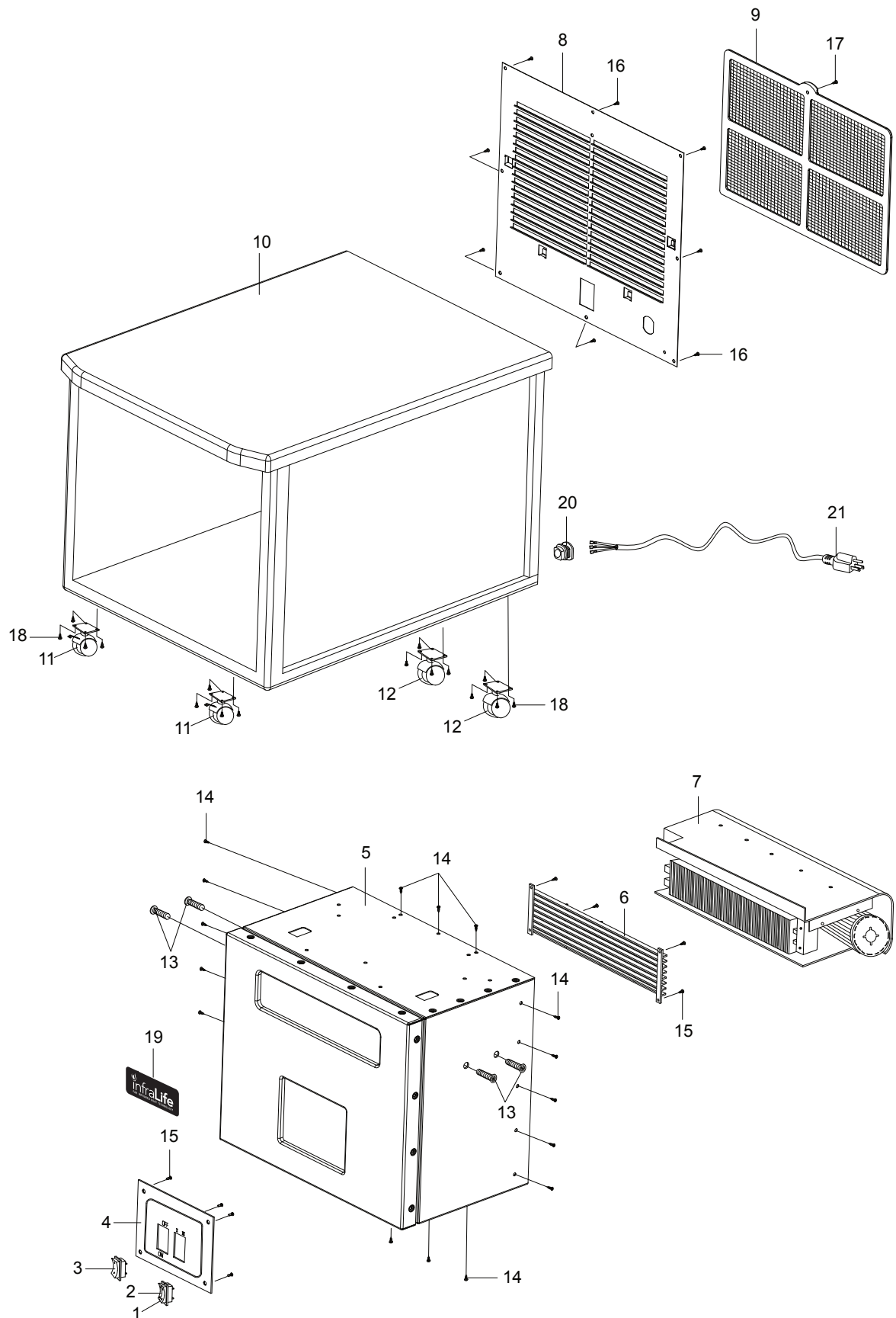

PART LIST

No.	Description	Qty	No.	Description	Qty
001	Temperature Level II Switch	1	012	Rear Caster Wheel	2
002	Temperature Level I Switch	1	013	Bolt KM4x15	4
003	Master Power Switch	1	014	Bolt PWA3x8	16
004	Control Panel	1	015	Bolt KM3x6	8
005	Metal Box	1	016	Bolt PWM4x12	8
006	Air Outlet	1	017	Bolt PWA4x12	1
007	PTC Heater	1	018	Bolt KA3x10	16
008	Metal Rear Cover	1	019	Logo Plate	1
009	Air Filter	1	020	Cable Gland	1
010	Wood Cabinet	1	021	Power Cord	1
011	Front Caster Wheel	2			

OPERATING INSTRUCTIONS

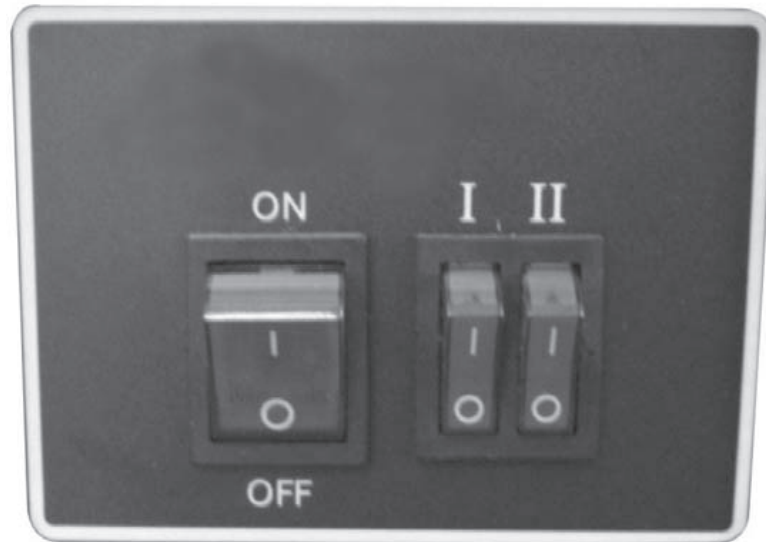

1. Plug the power cord into an appropriate socket or outlet.
2. Press the Master Power Switch to “ON” position on the control panel. The heater starts to blow air out from the front air outlet.
3. Press the Temperature Level I Switch to “I” position. The heater works on low temperature level performance.
4. Press the Temperature Level II Switch to “I” position. The heater works on high temperature level performance.
5. To turn off the heater, first press the Temperature Level II Switch to “O” position, then press the Temperature Level I Switch to “O” position. After 30 seconds, press the Master Power Switch to “OFF” position.
6. Unplug the heater when not in use.

Convert Watt to BTU: A British Thermal Unit (BTU) is the amount of heat energy needed to raise the temperature of one pound of water by one degree F. This is the standard measurement used to state the amount of energy that a fuel has as well as the amount of output of any heat generating device.

Low temperature mode

750W = 2559 BTU

High temperature mode

1500W = 5118 BTU

MAINTENANCE

1. Turn off the master power switch on the control panel.
2. Unplug the unit and wait until it is completely cool before clean.
3. To clean the heater, the outer surfaces of the heater may be cleaned with a soft, damp cloth and any mild detergent if necessary. After cleaning, dry the heater with a soft cloth.

CAUTION: Do not let liquid enter the heater.

4. Do not use abrasives or solvents to clean the heater. This may cause damage to the surface of the heater.
5. Do not drop the heater in water.
6. Wait until the heater is completely dry before use.

Cleaning the Air Filter

The heater comes equipped with a washable air filter. It is easy to be cleaned. We recommend the air filter to be cleaned once a month or if it appears to be blocking airflow. To do this, please follow the below steps.

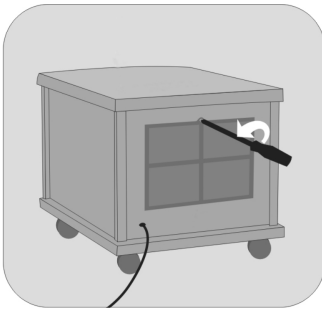

1. Loosen the bolt and remove it.

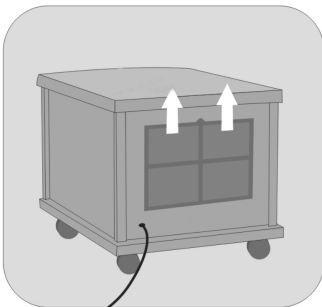

2. Gently remove the air filter from the rear of the heater.

3. Clean the filter by running clean water on the opposite direction of the air filter. You can also soak the air filter in water mixed with a small amount of mild dish soap. Then rinse with water after soaking.
4. Please allow it to drip dry completely before reinstalling.
5. Do not use heater with without air filter assembly in place.

Storage

Store the heater in a clean and dry location when not in use.

WARRANTY

Paradigm Health & Wellness, Inc. warrants to the original purchaser that this product is free from defects in material and workmanship when used for the purpose intended, under the conditions that it has been installed and operated in according to Paradigm Health & Wellness, Inc.'s Owner's Manual. Paradigm Health & Wellness, Inc.'s obligation under this warranty is limited to replacing free of charge, any parts which may prove to be defective under normal home use. This warranty does not include any damage caused by improper operation, misuse or commercial application. From the date of purchase, the product is warranted to be free from defects for 3 (three) years. Proof of purchase is required. This warranty is offered only to the original owner and is not transferable.

Ordering Replacement Parts

Replacement parts can be ordered by calling or emailing our customer service department

service@paradigmhw.com

1-866-924-1688

Monday through Friday, 8:00 AM - 5:00 PM (PST).

When ordering replacement parts please have the following information ready:

- 1. Owner's Manual**
- 2. Model Number**
- 3. Description of Parts**
- 4. Part Number**
- 5. Date of Purchase**

FAX FORM

Paradigm Health & Wellness, Inc.

PARTS REQUEST FAX FORM

Please fax this form to (1-626-810-2166)

OR YOU CAN EMAIL CUSTOMER SERVICE REQUESTS TO
service@paradigmhw.com

NAME: _____

ADDRESS: _____

CITY _____ STATE _____ ZIP _____

TELEPHONE: (Day) _____

(Night) _____

(Email Address) _____

SERIAL#: _____

MODEL#: _____

PURCHASE DATE: _____

PURCHASE FROM: _____

PART #	DESCRIPTION	QTY

“YOUR ORDER WILL BE PROCESSED WITHIN 3 BUSINESS DAYS”

OFFICIAL USE ONLY

SHIP DATE: _____

TRK #: _____

BACK ORDER: _____